

G.P.S. / GEODETIC SURVEY MONUMENT RECORD

SECTION 12, T 18 N, R 5 W, CITY/TOWN/VILLAGE BURNS

LA CROSSE COUNTY

LA CROSSE CO.
MONROE CO.

LOCATION SKETCH

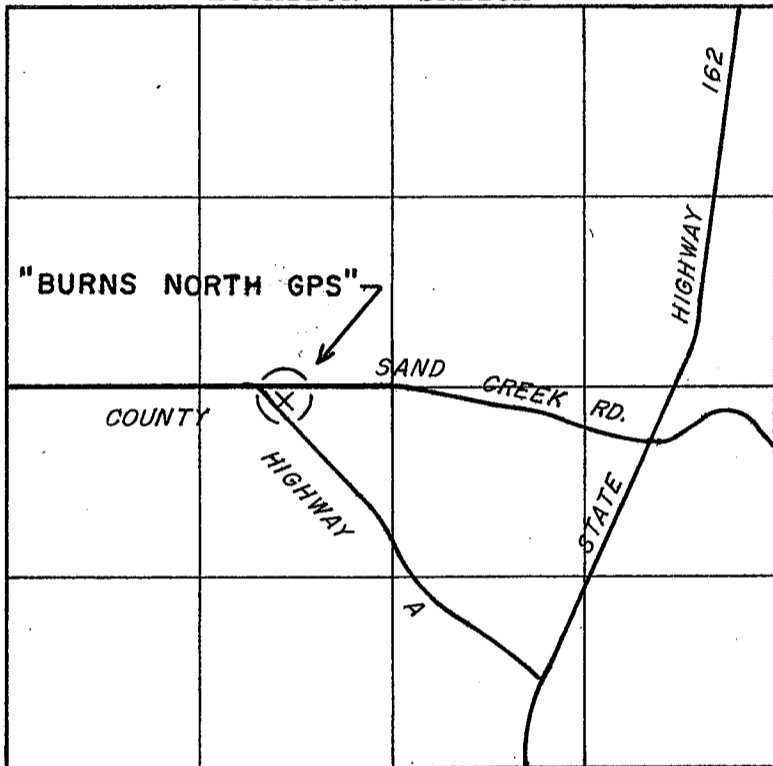

HORIZONTAL DATUM	
NAD 83(91):	
(Y)	<u>748,656.314565</u>
(X)	<u>1,724,878.375879</u>
NAD 27 _____:	
(Y)	_____
(X)	_____
OTHER: _____	
(Y)	_____
(X)	_____
VERTICAL DATUM	
ELEV. _____,	_____
ELEV. <u>882.4 ±</u> ,	<u>1929</u>
ELEV. _____,	<u>1988</u>

SECTION 12-18-5. (NOT TO SCALE)

Lat: 44°03'01.154900 N, (.00000m)
 Lon: 90°55'35.830740 W, (.00000m)
 Ell. Hgt in m: (236.3390m), (.00000m)

GPS / GEODETIC STATION DESCRIPTION

~~D.O.T. PROJECT I.D.:~~ LaCrosse Co. computer I.D. BURN

STATION NAME: "BURNS NORTH GPS" STATION NO. 185W12S

LATITUDE: N 44°03'01.15490" LONGITUDE: W 90°55'35.83074"

LOCAL NAME: Liebelt

MONUMENT BY AGENCY: County Surveyor DATE: 9/29/93 TYPE: Brass Cap in Conc.

SET BY: William C. Jung-(County Surveyor), Peter F. Follansbee.

MAINTENANCE RECORD:	<u>4/29/99</u>	<u>OK</u>	<u>weg</u>
MAINTENANCE RECORD:	<u>11/02/01</u>	<u>OK</u>	<u>weg</u>
MAINTENANCE RECORD:	<u>8/20/02</u>	<u>OK</u>	<u>weg</u>
MAINTENANCE RECORD:	<u>3/12/07</u>	<u>OK</u>	<u>weg</u>
MAINTENANCE RECORD:	<u>9/5/07</u>	<u>OK</u>	<u>weg</u>

The station is located in the northeast part of LaCrosse County more easily found beginning at the intersection of State Hwy 71 & State Hwy 162 in the unincorporated area known as Four Corners in Monroe C'ty, then traveling Southerly into LaCrosse C'ty and along St. Hwy 162 a dist. of 2.1 mi. to the intersection with Co. Hwy A. Then Northwest 0.5 mi. to the intersection of Co. Hwy A & Sand Creek Rd. where the 15" x 5' concrete marker with brass cap is found to the southeast of the intersection. (2.1 mi. = 3.38 km, 0.5 mi. = 0.80 km)

RECORD OF DURABLE WITNESS MONUMENTS

DETAIL SKETCH

(Not to scale)

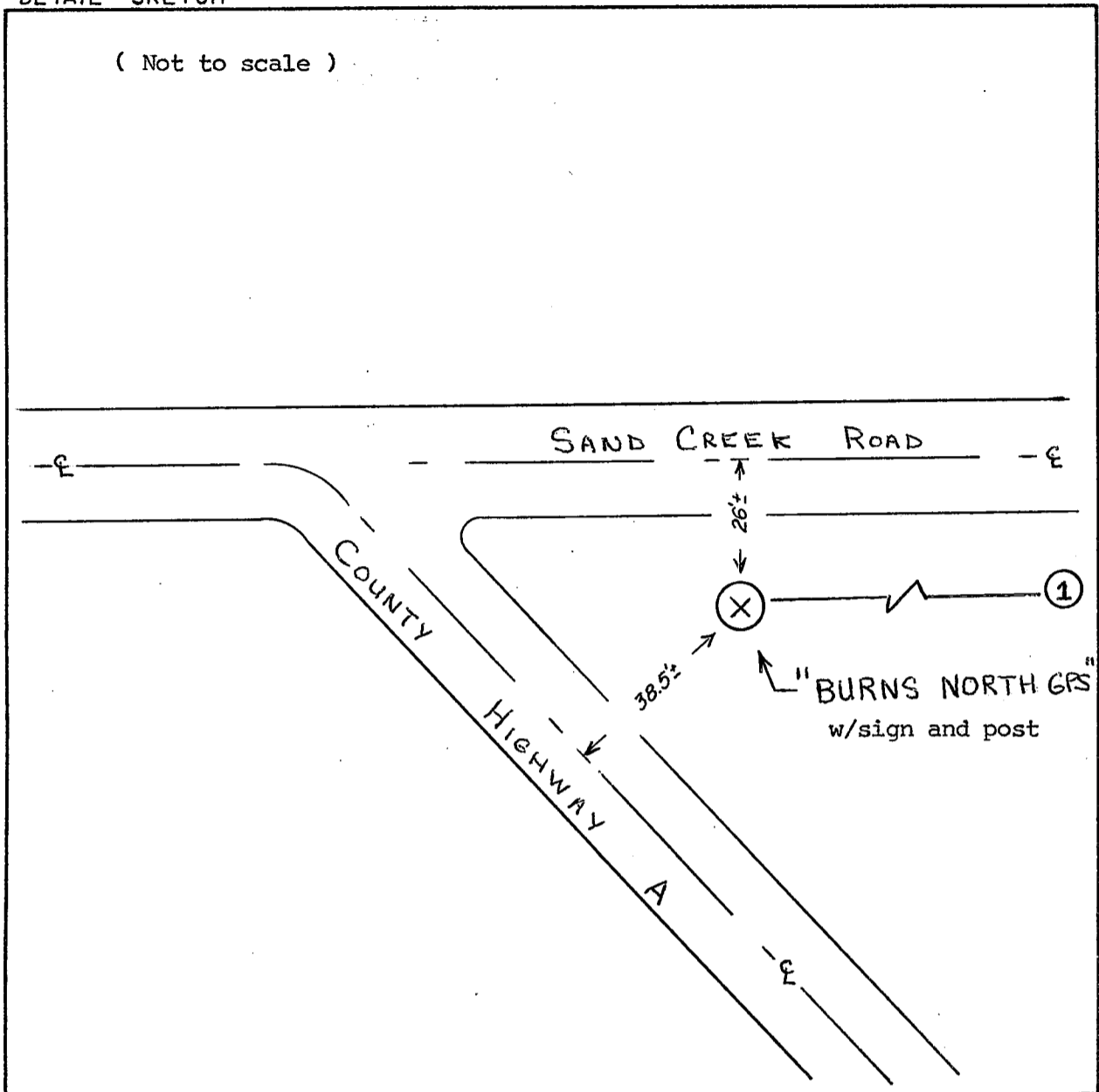

NO.	-DESCRIPTION	BEARING	DISTANCE
1	EX. BERNTSEN, C1/4-12-18-5	N89°39'38"W (grid)	920.337 (ground)

REMARKS: _____

I, William C. Jung, County Surveyor
 HEREBY CERTIFY THAT THE MONUMENT LOCATION SHOWN
 ON THIS RECORD WAS DETERMINED UNDER MY DIRECTION
 AND CONTROL AND THAT THIS GPS/GEODETIC RECORD IS
 CORRECT AND COMPLETE TO THE BEST OF MY KNOWLEDGE
 AND BELIEF.

William C. Jung
 SIGNATURE

2/8/00
 DATE

