

G.P.S. / GEODETIC SURVEY MONUMENT RECORD

SECTION 9, T 18 N, R 7 W, CITY/TOWN/VILLAGE HOLLAND

LA CROSSE COUNTY

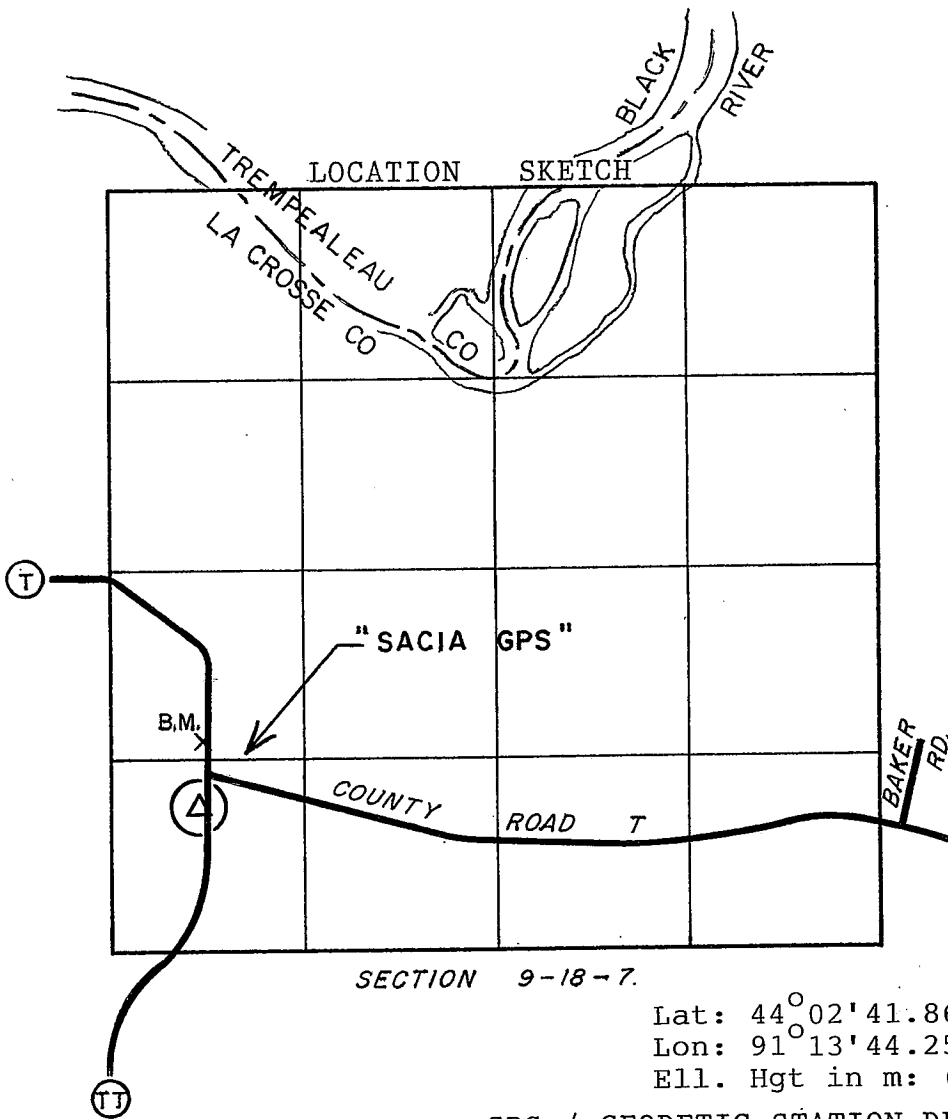

HORIZONTAL DATUM	
NAD 83(91):	
(Y)	747,730.777
(X)	1,645,365.239
NAD 27 :	
(Y)	
(X)	
OTHER:	
(Y)	
(X)	
VERTICAL DATUM	
ELEV.	
ELEV. <u>786.1 ±</u>	<u>1929</u>
ELEV.	<u>1988</u>

GPS / GEODETIC STATION DESCRIPTION

D.O.T. PROJECT I.D.: LaCrosse Co. computer I.D.: SACI

STATION NAME: "SACIA GPS" STATION NO. _____

LATITUDE: _____ LONGITUDE: _____

LOCAL NAME: _____

MONUMENT BY AGENCY: County Surveyor DATE: 11/09/94 TYPE: Brass cap in conc.

SET BY: William C. Jung-(County Surveyor) & Peter F. Follansbee.

MAINTENANCE RECORD:	<u>10/26/96</u>	<u>OK</u>	<u>wcj</u>	<u>10/4/07</u>	<u>OK</u>	<u>wcj</u>
MAINTENANCE RECORD:	<u>7/27/01</u>	<u>OK</u>	<u>wcj</u>			
MAINTENANCE RECORD:	<u>2/6/02</u>	<u>OK</u>	<u>wcj</u>			
MAINTENANCE RECORD:	<u>4/26/06</u>	<u>OK</u>	<u>wcj</u>			
MAINTENANCE RECORD:	<u>1/4/07</u>	<u>OK</u>	<u>wcj</u>			

The station is in the northwest part of LaCrosse County. More easily found beginning at the unincorporated area known as Stevenstown at the intersection of County Road V to the south and County Road T. Then traveling west along County Rd. T 2.8mi (4.5km) to the intersection with County Road TT and the 12" x 5' concrete marker with brass cap located in the roadway ditch 298ft. + (90.8m) south of the centerline intersection.

RECORD OF DURABLE WITNESS MONUMENTS

DETAIL SKETCH

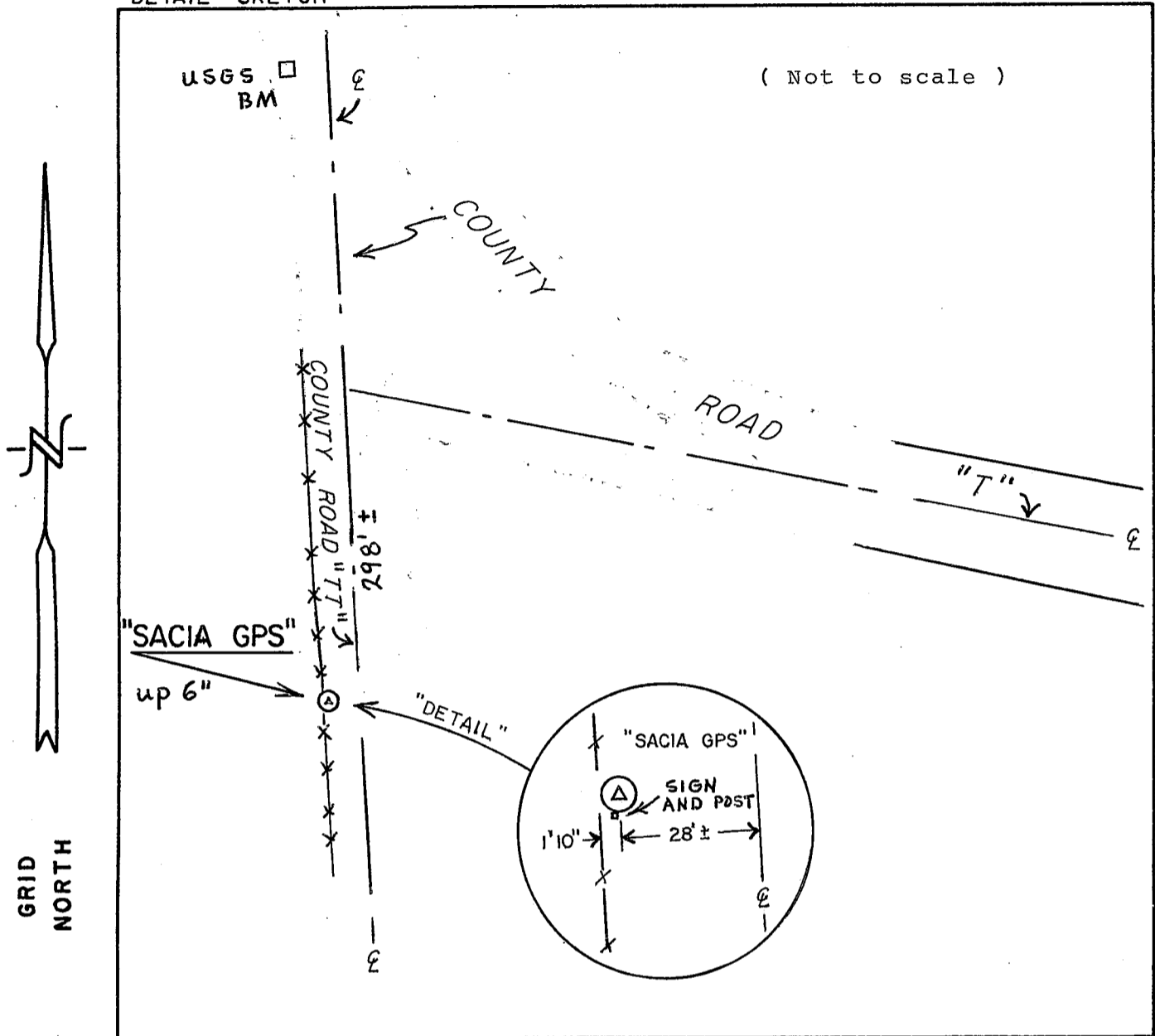

NO.	DESCRIPTION	BEARING	DISTANCE

REMARKS: _____

I, William C. Jung, County Surveyor
 HEREBY CERTIFY THAT THE MONUMENT LOCATION SHOWN
 ON THIS RECORD WAS DETERMINED UNDER MY DIRECTION
 AND CONTROL AND THAT THIS GPS/GEODETIC RECORD IS
 CORRECT AND COMPLETE TO THE BEST OF MY KNOWLEDGE
 AND BELIEF.

William C. Jung
 SIGNATURE

3/29/00
 DATE

