

23

Index of Sheets

Sheet No.	1	Title
Sheet No.	3	Typical Sections and Details
Sheet No.	3	Estimate of Quantities
Sheet No.	-	Miscellaneous Quantities
Sheet No.	-	Right of Way Plat
Sheet No.	5	Plan and Profile
Sheet No.	-	Standard Detail Drawings
Sheet No.	7 - 72	Standard Sign Plates
Sheet No.	-	Structure Plans
Sheet No.	-	Computer Earthwork Data
Sheet No.	-	Cross Sections

TOTAL SHEETS = 6



Design Designation

A.D.T.	=
A.D.T.	=
D.H.V.	=
D.	=
T.	=
V.	=

Conventional Signs

County Line	-----	Caution Symbol (Combustible fluids under pressure)	
Township or Range Line	-----	Railroads	+++++
Section Line	-----	Fence	---X---X---
Corporate or City Limits	//////	Culverts in Place	-----
Property line	-----	Culverts Required	-----
Lot Line	-----	Power Pole	-----
Existing Right of Way Line	-----	Telephone or Telegraph Pole	-----
New Right of Way Line	-----	Right of Way Markers	-----
Base or Survey Line	-----	Marsh	-----
Slope Intercept	-----	Wooded Area	-----
Existing Roadway or Private Entrance	-----	Grade Elevation	-----

STATE OF WISCONSIN DEPARTMENT OF TRANSPORTATION

PLAN OF PROPOSED IMPROVEMENT CASS STREET BRIDGE, CITY OF LA CROSSE BRIDGE LIGHTING U.S.H. 14 LA CROSSE COUNTY

STATE PROJECT NUMBER
5200-3-71



Scales

BEGIN PROJECT 5200-3-71
STA. 38 + 09.25
N = 662,300 (± 200')
E = 1,666,500 (± 200')
3700' WEST & 400' SOUTH OF THE
N.E. CORNER SECTION 6, T15N, R7W

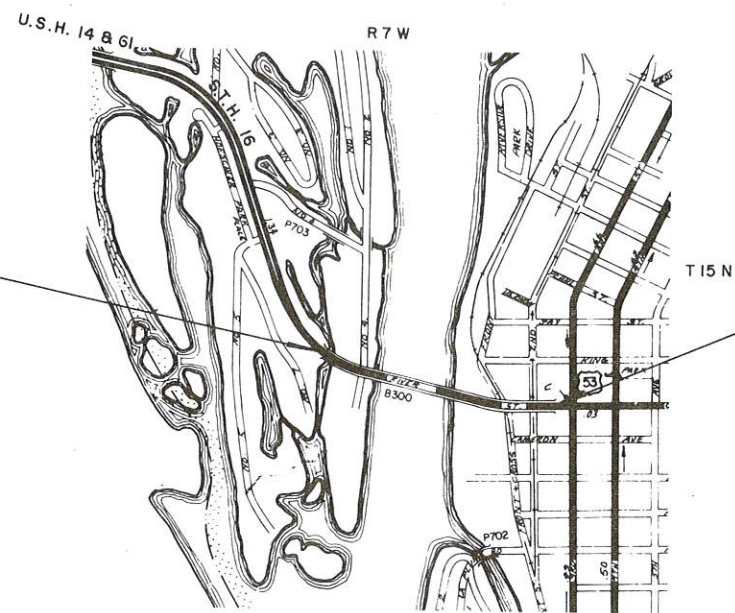

END PROJECT 5200-3-71
STA. 65 + 16.10
N = 661,700 (± 200')
E = 1,669,100 (± 200')
1000' WEST & 1000' SOUTH OF THE
N.E. CORNER SECTION 6, T15N, R7W

Layout
Scale 0 500 1000 FT.

Total Net Length of Centerline = 0.513 Mi. URBAN



STATE PROJECT	FEDERAL PROJECT	
	PROJECT	CONTRACT
5200-3-71	HES 056(1)	I

APPROVED FOR
CITY OF LA CROSSE

DATE 5/18/79 *Bob D. Schroeder*
DIRECTOR OF PUBLIC WORKS

STATE OF WISCONSIN
DEPARTMENT OF TRANSPORTATION

Surveyor _____ District Checker L.A.B.
Designer _____ C.O. Checker J.R.T.
District Supervisor R.V.R. C.O. Coordinator R.H.R.

Approved: _____
Date 5-8-79 *T.R. Kinsey*
District Transportation Director

Approved: _____
Date 6-7-79 *J.H. King*
Chief Traffic Engineer

Approved: _____
Date 6-7-79 *W.J. Strand*
Chief Design Engineer

Approved: _____
Date 6/8/79 *E.J. Byrkit*
Director of Development

U.S. DEPARTMENT OF TRANSPORTATION
FEDERAL HIGHWAY ADMINISTRATION
REGION 5 WISCONSIN DIVISION

Approved: _____
Date _____
Division Administrator

NOTE: COORDINATES SHOWN ARE WISCONSIN COORDINATE SYSTEM SOUTH ZONE COORDINATE AND SCALED FROM U.S.G.S. TOPOGRAPHIC MAP LA CRESNET, MINN. QUADRANGLE FOR IDENTIFICATION ONLY.

STATE PROJECT NUMBER	SHEET NO.
5200-3-71	5
5200-3-71	

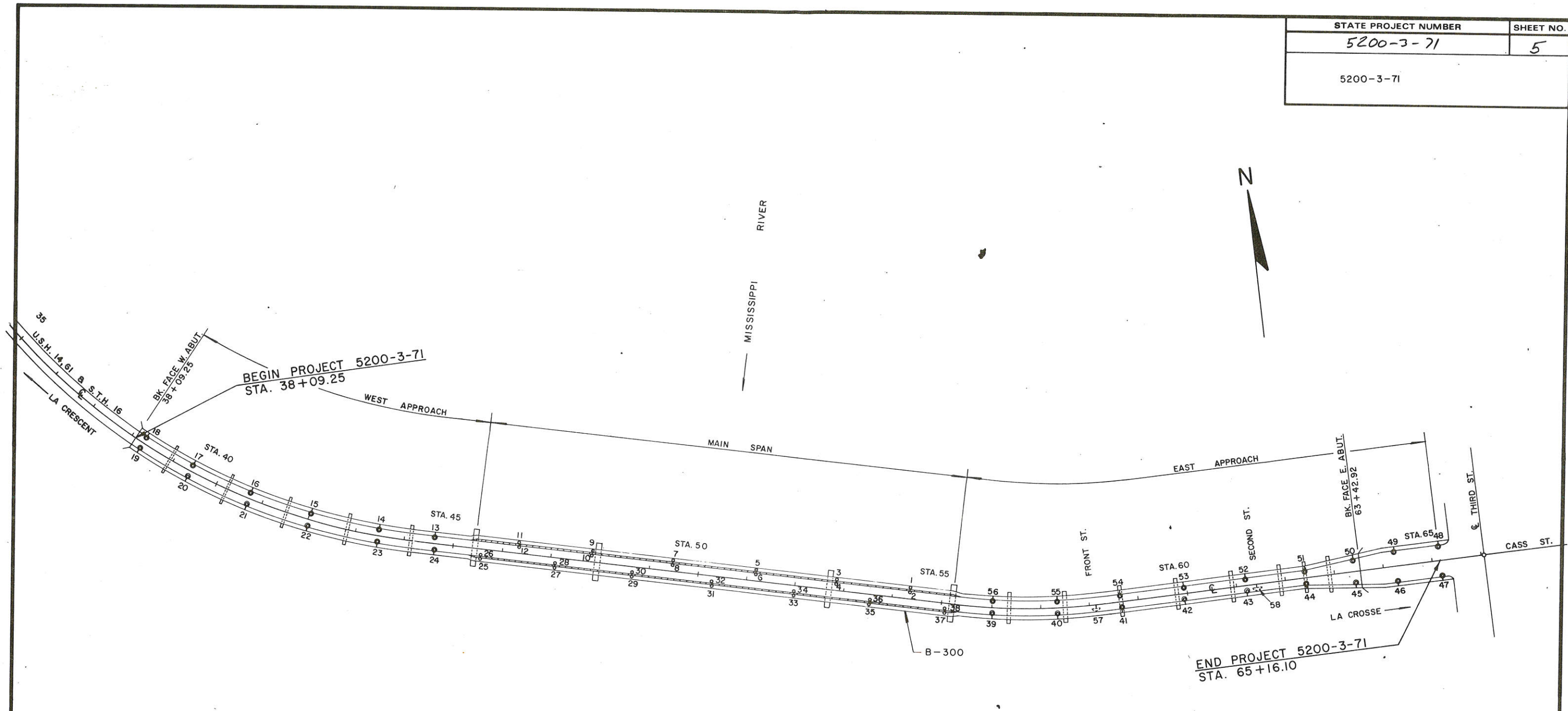

LAYOUT

NOTE:
 THE NAVIGATION AND OBSTRUCTION LIGHTS
 AND THE STAIRWAY LIGHTS ON THE WEST APPROACH
 ARE ON SEPARATE CIRCUITS AND NOT A PART OF
 THIS CONTRACT.

- LEGEND
- ⊙.....POLE MOUNTED LUMINAIRE
 -BRACKET MOUNTED LUMINAIRE
 - ⊚.....UNDER FLOOR LUMINAIRE

PROJECT I. D.	SHEET NUMBER	TOTAL SHEETS
PROJECT DESIGNATION		

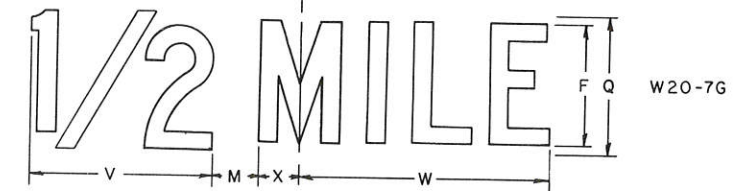
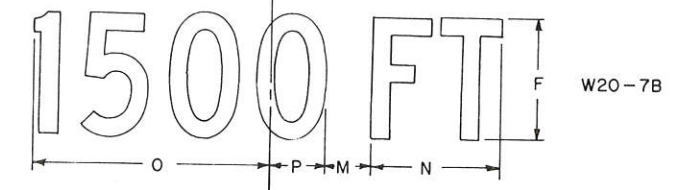
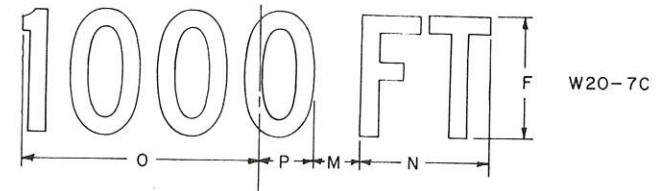
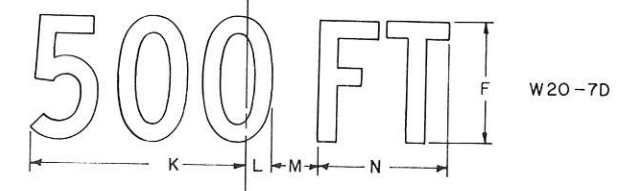
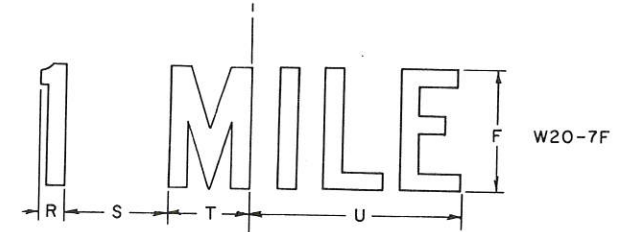
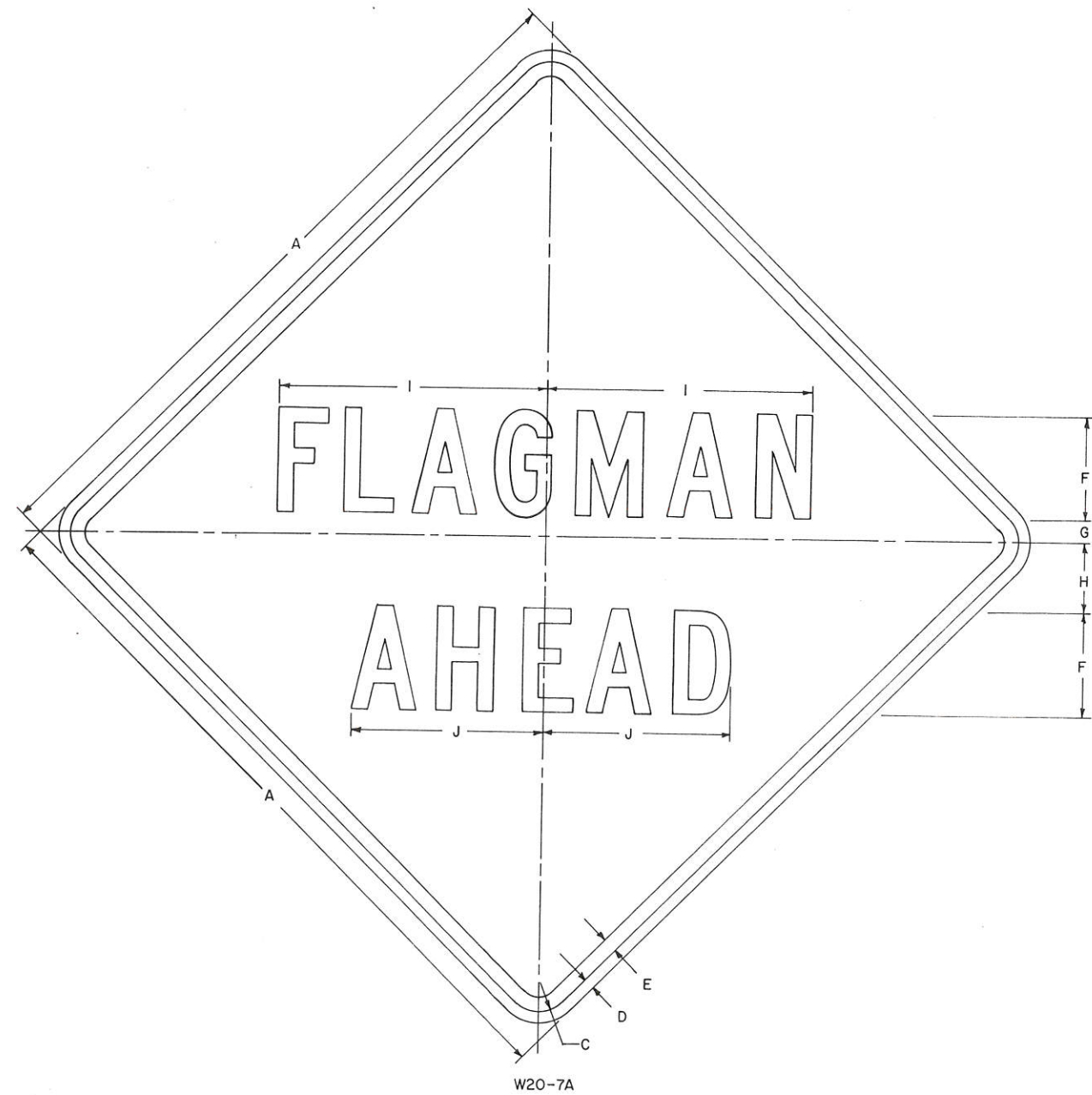

NOTES:

- Sign is Type II
- Color:
Background - Non-Reflective Orange
Message - Black
- Face Material - Paint
- Corners may be square or rounded when base material is plywood but borders shall be rounded as shown. When base material is metal, the corners and borders shall be rounded.
- All letters & numbers are Series "C"
- Substitute distances shown for "AHEAD" as Code requires.
- This drawing may be scaled for Standard Size only.

SIZE	CODE SIZE	A	B	C	D	E	F	G	H	I	J	K	L	M	N	O	P	Q	R	S	T	U	V	W	X	Y	Z	Bid Area Sq. Ft.
Minimum	1	36		1 5/8	5/8	3/4	5	1 1/8	3 9/16	12 7/8	9 1/16	8 9/16	1 5/16	1 7/8	5 3/8	9 5/8	2 3/8	6	1	4 1/4	3 5/16	8 11/16	7 3/8	10 1/4	1 11/16		9.00	
Standard	2	48		2 1/4	3/4	1	7	1 1/2	4 3/4	18	12 5/8	12	1 7/8	2 3/8	7 1/2	13 1/2	3 3/8	8	1 7/16	6	4 5/8	12 1/8	10 5/8	14 3/8	2 3/8		16.00	
Oversize	3	48		2 1/4	3/4	1	7	1 1/2	4 3/4	18	12 5/8	12	1 7/8	2 3/8	7 1/2	13 1/2	3 3/8	8	1 7/16	6	4 5/8	12 1/8	10 5/8	14 3/8	2 3/8		16.00	
Exp-way	4	48		2 1/4	3/4	1	7	1 1/2	4 3/4	18	12 5/8	12	1 7/8	2 3/8	7 1/2	13 1/2	3 3/8	8	1 7/16	6	4 5/8	12 1/8	10 5/8	14 3/8	2 3/8		16.00	
Freeway	5	48		2 1/4	3/4	1	7	1 1/2	4 3/4	18	12 5/8	12	1 7/8	2 3/8	7 1/2	13 1/2	3 3/8	8	1 7/16	6	4 5/8	12 1/8	10 5/8	14 3/8	2 3/8		16.00	
		AA	BB	CC	DD	EE	FF	GG	HH	II	JJ	KK	LL	MM	NN	OO	PP	QQ	RR	SS	TT	UU	VV	WW	XX	YY	ZZ	
Minimum	1																											
Standard	2																											
Oversize	3																											
Exp-way	4																											
Freeway	5																											

Date Drawn - 7/26/62 Date Redrawn - 9/15/72 *wsk*

Date Revised - 6-23-65
9-15-72

STANDARD SIGN
W20-7A,B,C,D,F & G

WISCONSIN DIVISION OF HIGHWAYS

APPROVED *[Signature]*
CHIEF TRAFFIC ENGINEER

DATE 6-7-78 PLATE NO. W20-74

SIZE	CODE	A	B	C	D	E	F	G	H	I	J	K	L	M	N	O	P	Q	R	S	T	U	V	W	X	Y	Z
Minimum	1	30	10 1/4	10 1/4	6	6.25																					
Standard	2	36	12 1/2	12 1/2	7	9.00																					
Overize	3	36	15 1/8	15 1/8	7	9.00																					
Exp-way	4	36	15 1/8	15 1/8	7	9.00																					
Free-way	5	48	21 1/4	21 1/4	9	16.00																					
Minimum	1																										
Standard	2																										
Overize	3																										
Exp-way	4																										
Free-way	5																										

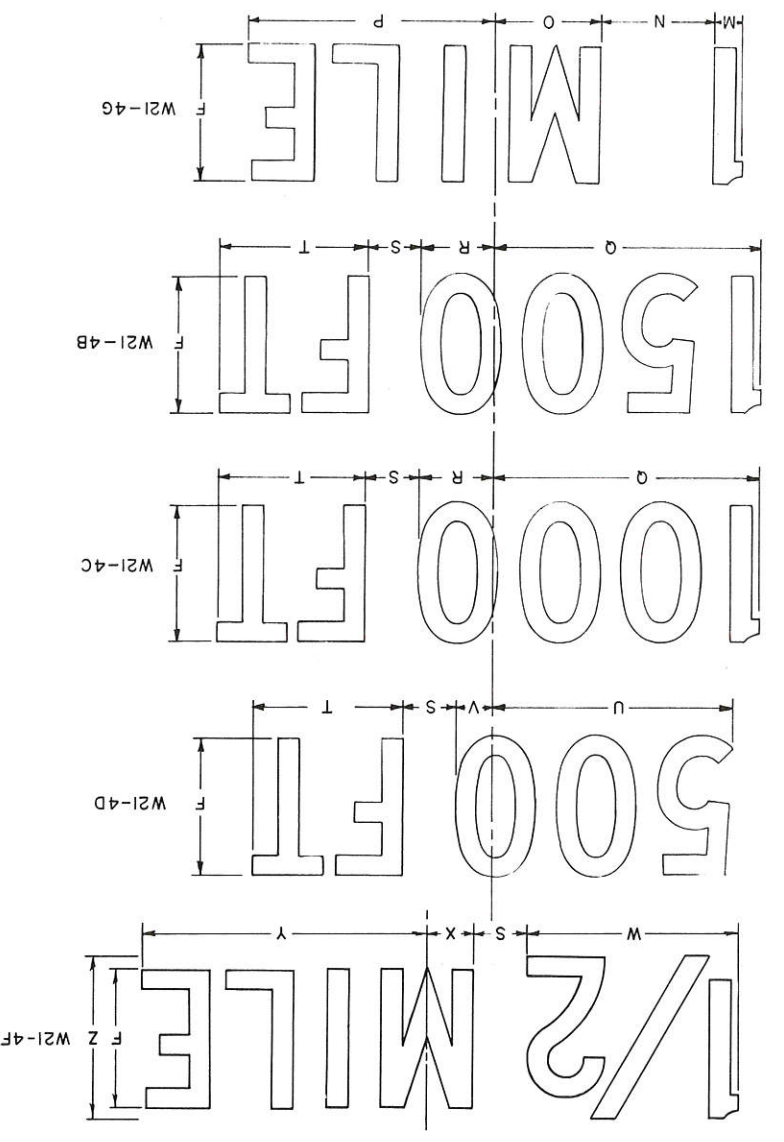
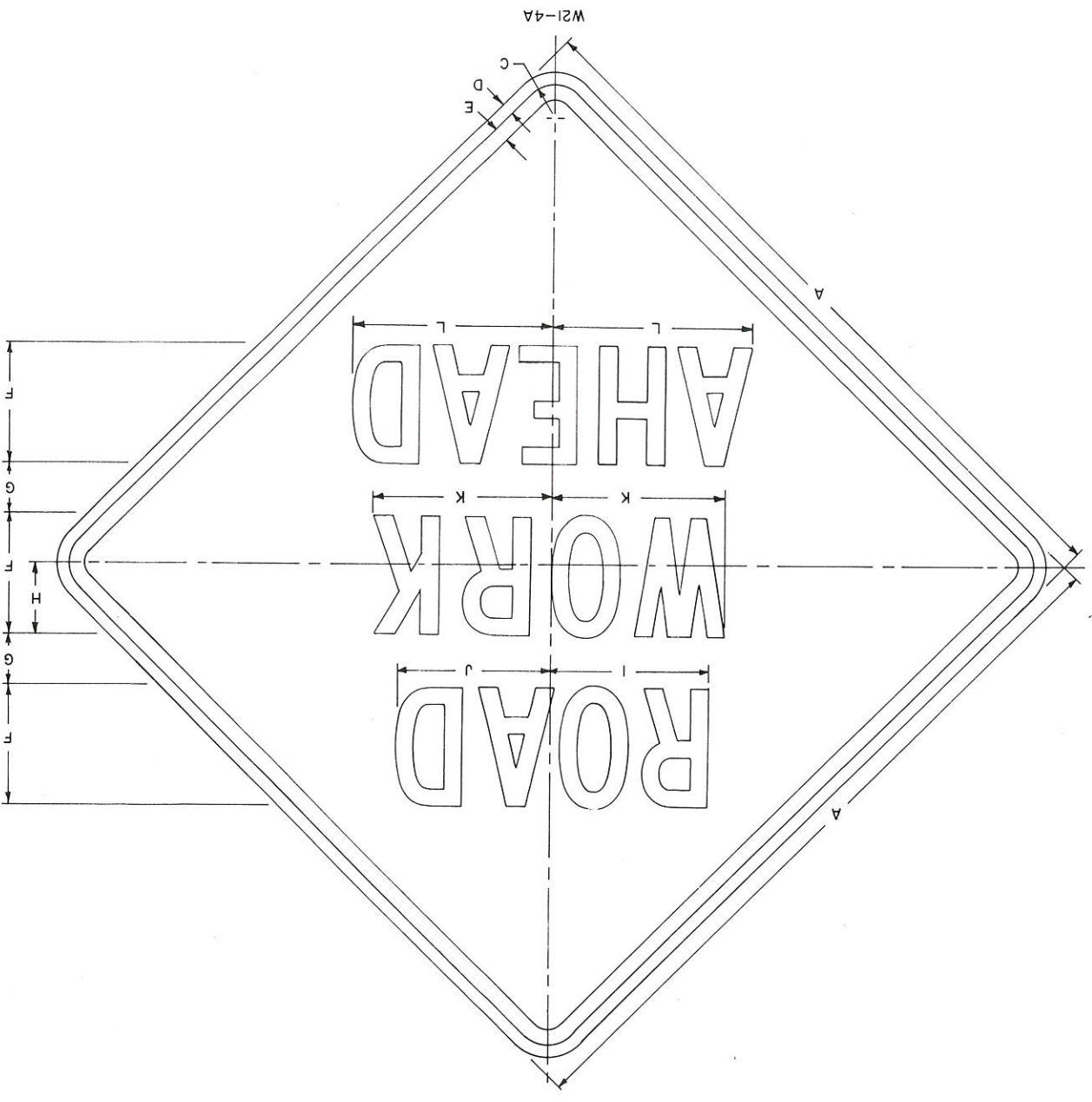

- NOTES:
1. Sign is Type II
 2. Color: Background - Non-Reflective Orange
Message - Black
 3. Face Material - Non-Reflective Sheeting
 4. Corners may be square or rounded when base material is plywood but borders shall be rounded as shown. When base material is metal, the corners and borders shall be rounded.
 5. This drawing may be scaled for standard size only.
 6. All letters series "C"
 7. When sign is used at night background shall be reflectorized.

PROJECT I.D.	PROJECT DESIGNATION
SHEET NUMBER	
TOTAL SHEETS	

Date Drawn - 9-17-62 Date Redrawn - 7-28-72
 Date Revised - 5-19-72
 7-28-72
 4-24-78
 STANDARD SIGN
 W21-4A,B,C,D,F&G
 WISCONSIN DIVISION OF HIGHWAYS
 APPROVED
 CHIEF TRAFFIC ENGINEER
 DATE 7-3-78 PLATE NO. W21-44

Plan # 255