

R/W PROJECT NUMBER 7571-05-21	SHEET NUMBER 4.0	TOTAL SHEETS 3
FEDERAL PROJECT NUMBER		
PLAT OF RIGHT OF WAY REQUIRED FOR		
S.T.H. 162 - C.T.H. "E"		
S.T.H. 162 INTERSECTION		
S.T.H. 16	LA CROSSE COUNTY	

CONVENTIONAL SIGNS AND ABBREVIATIONS

LINES & SYMBOLS

STATE		LOT & TIE	
COUNTY		SLOPE INTERCEPTS	
TOWNSHIP & RANGE		UNDERGROUND UTILITY	
SECTION		IRON PIN/PIPE	
QUARTER		POWER POLE	
SIXTEENTH		TELEPHONE POLE	
NEW CENTERLINE		TELEPHONE PEDESTAL	
NEW R/W		MONUMENTED R/W POINT	
OLD R/W		NO ACCESS (TO BE ACQUIRED)	
PROPERTY LINE		NO ACCESS (PRIOR ACQUISITION)	
CORPORATE LIMITS		NO ACCESS (BY STATUTE)	

ABBREVIATIONS

AP	ACCESS POINT	MON	MONUMENT
AH	AHEAD		
ARC	ARC LENGTH	OL	OUTLOT
BK	BACK	PC	POINT OF CURVATURE
B.	BARN	PI	POINT OF INTERSECTION
BLK	BLOCK	PT	POINT OF TANGENCY
		PCC	POINT OF COMPOUND CURVATURE
CEM.	CEMETERY	PL	PROPERTY LINE
C	CENTERLINE	PLE	PERMANENT LIMITED EASEMENT
CH	CHANNEL	R	RADIUS
CH-CH	CHANNEL CHANGE	RL	REFERENCE LINE
C.T.H.	COUNTY TRUNK HIGHWAY	R/W	RIGHT OF WAY
		REM	REMAINING
D	DEGREE OF CURVE	RES	RESTAURANT
ET. AL.	AND OTHERS	SEC	SECTION
EX.	EXISTING	SS	SERVICE STATION
		S	SHED
FDN.	FOUNDATION	S.T.H.	STATE TRUNK HIGHWAY
		STA	STATION
		ST	STORE
G.	GARAGE	T.	TANGENT LENGTH OF CURVE
G.L.	GOVERNMENT LOT	TAV	TAVERN
G.N.	GRID NORTH	TEMP.	TEMPORARY
		T	TRANSIT LINE
		T.L.E.	TEMPORARY LIMITED EASEMENT
H.	HOUSE	USH	UNITED STATES HIGHWAY
HT	HOUSE TRAILER		
I.H.	INTERSTATE HIGHWAY	WH	WAREHOUSE
I.P.	IRON PIN/PIPE	X	EAST GRID COORDINATE
L	LENGTH OF CURVE	Y	NORTH GRID COORDINATE
LC	LAND CONTRACT/LONG CHORD		
L.E.	LIMITED EASEMENT		
L.C.B.	LONG CHORD BEARING		

NOTES

COORDINATES AND BEARINGS ON THIS PLAT ARE ORIENTED TO THE WISCONSIN COORDINATE SYSTEM SOUTH ZONE. ALL DISTANCES ARE GROUND LENGTH AND MAY BE CONVERTED TO GRID LENGTH BY MULTIPLYING THE DISTANCE BY THE GRID FACTOR PROVIDED ON THE DETAIL SHEET.

RIGHT OF WAY MONUMENTS ARE TYPE 2 AND ARE PLACED PRIOR TO OR AT THE TIME OF LAND TITLE TRANSFER.

RIGHT OF WAY BOUNDARIES ARE DEFINED WITH COURSES OF THE PERIMETER OF THE UNDIVIDED LANDS REFERENCED TO THE U.S. PUBLIC LAND SURVEY OR OTHER SURVEYS OF PUBLIC RECORD.

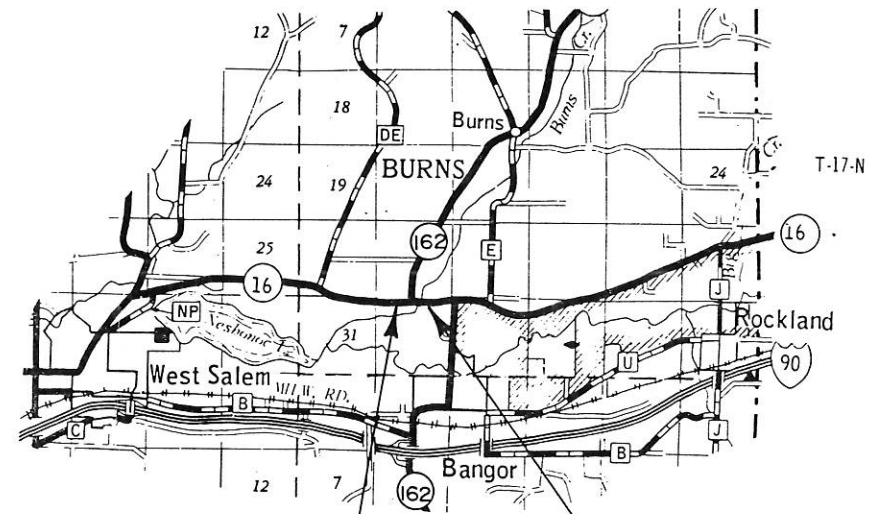

BEGIN RELOCATION ORDER

N 89°-28'-32" E 2350.50'
FROM THE N.W. COR. SEC. 32,
T17N, R5W

END RELOCATION ORDER

N 89°-44'-14" W 1860.86'
FROM THE N.E. COR. OF SEC. 32,
T17N, R5W

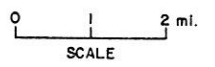

TOTAL NET LENGTH OF CENTERLINE = 0.208 MI.

REVISION DATE	STATE OF WISCONSIN DEPARTMENT OF TRANSPORTATION
APPROVED:	
DATE: <i>3/24/92</i>	DISTRICT TRANSPORTATION DIRECTOR
	U.S. DEPARTMENT OF TRANSPORTATION FEDERAL HIGHWAY ADMINISTRATION REGION 5 WISCONSIN DIVISION
APPROVED:	
DATE:	DIVISION ADMINISTRATOR

SCHEDULE OF LANDS & INTERESTS REQUIRED

AREAS SHOWN IN THE TOTAL ACRES COLUMN MAY BE APPROXIMATE AND ARE DERIVED FROM TAX ROLLS OR OTHER AVAILABLE SOURCES AND MAY NOT INCLUDE LANDS OF THE OWNER WHICH ARE NOT CONTIGUOUS TO THE AREA TO BE ACQUIRED.

REVISION DATE

ROUTE COUNTY DATE
 S.T.H. 16 LA CROSSE 3-20-92

R/W PROJECT NUMBER	7571-05-21	SHEET NUMBER	
FEDERAL PROJECT NUMBER			4.1

PARCEL NUMBER	SHEET NUMBER	OWNER	INTERESTS REQUIRED	TOTAL BEFORE AC/SF	AC./SF. REQUIRED			TOTAL REM AC./SF	LE. AC./SF	
					NEW	EXIST	TOTAL		PERM	TEMP.
1	4.2	MYRON E. & ALICE M. PFAFF	FEE	2.99	0.02	—	0.02	2.97	—	—
2	4.2	HARLAN L. & LINDA L. HORSWILL	FEE & T.L.E.	6.51	0.05	—	0.05	6.46	—	0.04
3	4.2	RICHARD & LOUISE EVANS	P.L.E. & T.L.E.	157.11	—	—	—	157.11	0.54	0.24

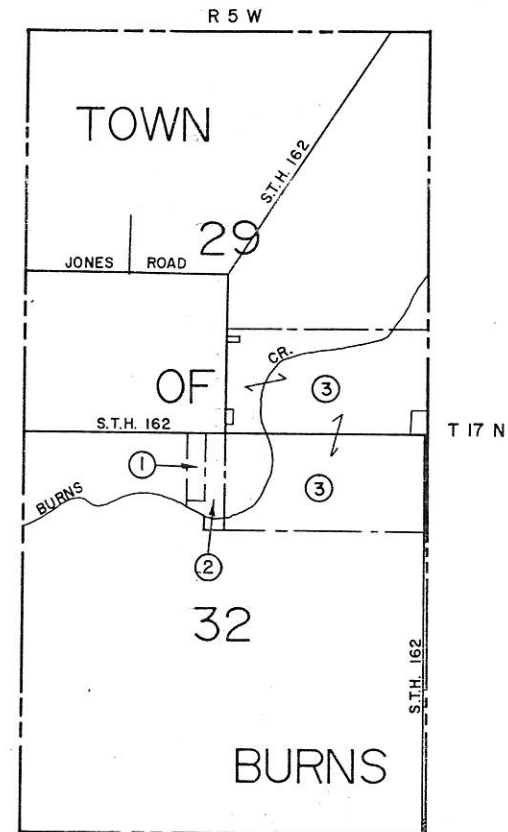

NOT TO SCALE

REVISION DATE	ROUTE	COUNTY	DATE	R/W PROJECT NUMBER	SHEET NUMBER
	S.T.H. 16	LA CROSSE	3-20-92	7571-05-21	
	SCALE, FT.	GRID FACTOR		FEDERAL PROJECT NUMBER	4.2
	0 50 100	0.99994020			

TOWN

GN

SE-SW

SW-SE

RICHARD & LOUISE EVANS

BEGIN RELOCATION ORDER

STA. 789+00
 X = 1,704,527.502
 Y = 699,085.544

T.L.E. FOR SLOPES
 0.17 AC.

P.L.E. FOR DRAINAGE
 0.31 AC.

T.L.E. FOR DRIVEWAY
 0.03 AC.

X = 1,707,386.210
 Y = 699,027.945
 "DRILL HOLE IN CONCRETE"

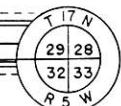
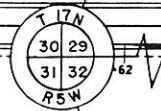

"BRASS CAP LUNDY MARKER"
 X = 1,702,075.310
 Y = 699,022.226

END RELOCATION ORDER
 STA. 800+00
 X = 1,705,627.412
 Y = 699,078.285

MYRON E. & ALICE M. PFAFF

HARLAN L. & LINDA L. HORSWILL

RICHARD & LOUISE EVANS

NE-NW

NW-SE

BURNS

**CONVENTIONAL SIGNS AND ABBREVIATIONS
LINES & SYMBOLS**

STATE	---	LOT & TIE	---
COUNTY	---	SLOPE INTERCEPTS	---
TOWNSHIP & RANGE	---	UNDERGROUND UTILITY	---
SECTION	---	IRON PIN/PIPE	○
QUARTER	---	POWER POLE	□
SIXTEENTH	---	TELEPHONE POLE	⊗
NEW CENTERLINE	—○—○—	TELEPHONE PEDESTAL	□TP
NEW R/W	—○—○—	MONUMENTED R/W POINT	○
OLD R/W	---	NO ACCESS (TO BE ACQUIRED)	---
PROPERTY LINE	---	NO ACCESS (PRIOR ACQUISITION)	---
CORPORATE LIMITS	///	NO ACCESS (BY STATUTE)	●●●●●●●●

ABBREVIATIONS

AP	ACCESS POINT	MON	MONUMENT
AH	AHEAD		
ARC	ARC LENGTH	OL	OUTLOT
BK	BACK	PC	POINT OF CURVATURE
B.	BARN	P.I.	POINT OF INTERSECTION
BLK	BLOCK	P.T.	POINT OF TANGENCY
		PCC	POINT OF COMPOUND CURVATURE
CEM.	CEMETERY	PL	PROPERTY LINE
C.	CENTERLINE	P.L.E.	PERMANENT LIMITED EASEMENT
CH	CHANNEL	R	RADIUS
CH-CH	CHANNEL CHANGE	R/L	REFERENCE LINE
C.T.H.	COUNTY TRUNK HIGHWAY	R/W	RIGHT OF WAY
		REM	REMAINING
D	DEGREE OF CURVE	RES	RESTAURANT
ET. AL.	AND OTHERS	SEC	SECTION
EX.	EXISTING	SS	SERVICE STATION
		S	SHED
		S.T.H.	STATE TRUNK HIGHWAY
FDN.	FOUNDATION	STA	STATION
		ST	STORE
G.	GARAGE	T.	TANGENT LENGTH OF CURVE
G.L.	GOVERNMENT LOT	TAV	TAVERN
G.N.	GRID NORTH	TEMP	TEMPORARY
		T	TRANSIT LINE
		T.L.E.	TEMPORARY LIMITED EASEMENT
H.	HOUSE	U.S.H.	UNITED STATES HIGHWAY
H.T.	HOUSE TRAILER	WH	WAREHOUSE
I.H.	INTERSTATE HIGHWAY	X	EAST GRID COORDINATE
I.P.	IRON PIN/PIPE	Y	NORTH GRID COORDINATE
L	LENGTH OF CURVE		
LC	LAND CONTRACT/LONG CHORD		
L.E.	LIMITED EASEMENT		
L.C.B.	LONG CHORD BEARING		

NOTES

COORDINATES AND BEARINGS ON THIS PLAT ARE ORIENTED TO THE WISCONSIN COORDINATE SYSTEM SOUTH ZONE. ALL DISTANCES ARE GROUND LENGTH AND MAY BE CONVERTED TO GRID LENGTH BY MULTIPLYING THE DISTANCE BY THE GRID FACTOR PROVIDED ON THE DETAIL SHEET.

RIGHT OF WAY MONUMENTS ARE TYPE 2 AND ARE PLACED PRIOR TO OR AT THE TIME OF LAND TITLE TRANSFER.

RIGHT OF WAY BOUNDARIES ARE DEFINED WITH COURSES OF THE PERIMETER OF THE LANDS REFERENCED TO THE U.S. PUBLIC LAND SURVEY OR OTHER SURVEYS OF PUBLIC RECORD.

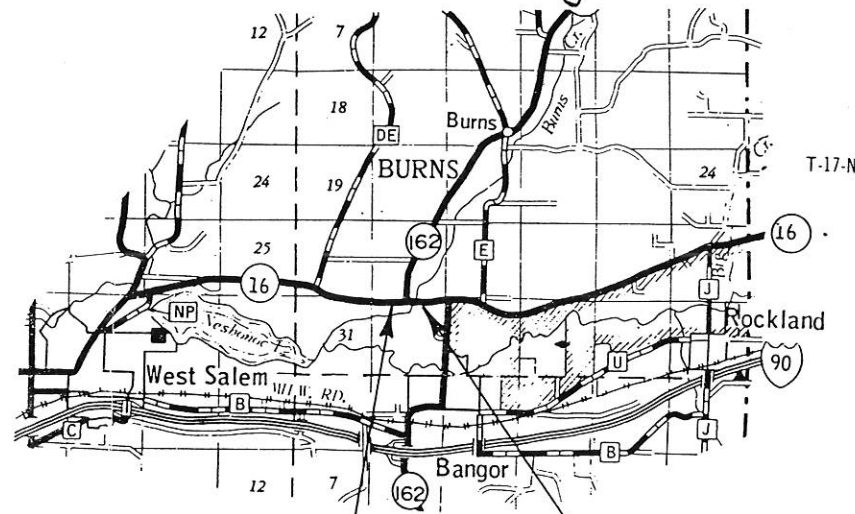

BEGIN RELOCATION ORDER

N 89°-28'-32" E 2350.50'
FROM THE N.W. COR. SEC. 32,
T17N, R5W

END RELOCATION ORDER

N 89°-44'-14" W 1860.86'
FROM THE N.E. COR. OF SEC. 32,
T17N, R5W

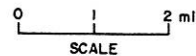

R/W PROJECT NUMBER 7571-05-21	SHEET NUMBER 4.0	TOTAL SHEETS 3
FEDERAL PROJECT NUMBER		
PLAT OF RIGHT OF WAY REQUIRED FOR S.T.H. 162 - C.T.H. "E" S.T.H. 162 INTERSECTION S.T.H. 16 LA CROSSE COUNTY		

TOTAL NET LENGTH OF CENTERLINE = 0.208 MI.

REVISION DATE	STATE OF WISCONSIN DEPARTMENT OF TRANSPORTATION
	APPROVED:
	DATE: <i>W. J. J. J.</i> 3/24/92 DISTRICT TRANSPORTATION DIRECTOR
	U.S. DEPARTMENT OF TRANSPORTATION FEDERAL HIGHWAY ADMINISTRATION REGION 5 WISCONSIN DIVISION
	APPROVED:
	DATE: _____ DISTRICT ADMINISTRATION

SCHEDULE OF LANDS & INTERESTS REQUIRED

AREAS SHOWN IN THE TOTAL ACRES COLUMN MAY BE APPROXIMATE AND ARE DERIVED FROM TAX ROLLS OR OTHER AVAILABLE SOURCES AND MAY NOT INCLUDE LANDS OF THE OWNER WHICH ARE NOT CONTIGUOUS TO THE AREA TO BE ACQUIRED.

REVISION DATE	ROUTE	COUNTY	DATE	R/W PROJECT NUMBER	SHEET NUMBER
	S.T.H. 16	LA CROSSE	3-20-92	7571-05-21	4.1
				FEDERAL PROJECT NUMBER	

PARCEL NUMBER	SHEET NUMBER	OWNER	INTERESTS REQUIRED	TOTAL BEFORE AC/SF	AC/SF REQUIRED			TOTAL REM. AC/SF	L.E. AC/SF	
					NEW	EXIST.	TOTAL		PERM.	TEMP.
1	4.2	MYRON E. & ALICE M. PFAFF	FEE	2.99	0.02	—	0.02	2.97	—	—
2	4.2	HARLAN L. & LINDA L. HORSWILL	FEE & T.L.E.	6.51	0.05	—	0.05	6.46	—	0.04
3	4.2	RICHARD & LOUISE EVANS	P.L.E. & T.L.E.	157.11	—	—	—	157.11	0.54	0.24

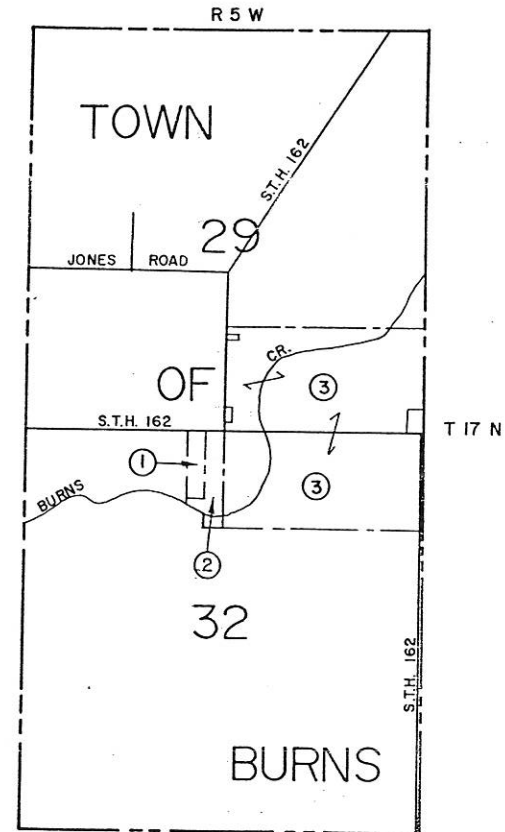

NOT TO SCALE

REVISION DATE	ROUTE	COUNTY	DATE	R/W PROJECT NUMBER	SHEET NUMBER
	S.T.H. 16	LA CROSSE	3-20-92	7571-05-21	4.2
	SCALE, FT.	GRID FACTOR		FEDERAL PROJECT NUMBER	
	0 50 100	0.99994020			

TOWN

GN

SW-SE

SE-SW

RICHARD & LOUISE EVANS

T.L.E. FOR SLOPES
0.17 AC.

T.L.E. FOR DRIVEWAY
0.03 AC.

P.L.E. FOR DRAINAGE
0.31 AC.

BEGIN RELOCATION ORDER

STA. 789+00
X = 1,704,527.502
Y = 699,085.544

X = 1,707,386.210
Y = 699,027.945
"DRILL HOLE IN CONCRETE"

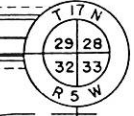
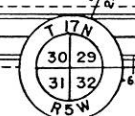

*BRASS CAP LUNDY MARKER
X = 1,702,075.310
Y = 699,022.226

END RELOCATION ORDER

STA. 800+00
X = 1,705,627.412
Y = 699,078.285

MYRON E. & ALICE M. PFAFF

T.L.E. FOR DRIVEWAY
0.04 AC.

T.L.E. FOR DRIVEWAY
0.04 AC.

RICHARD & LOUISE EVANS

OUTLOT 2
CSM 210

HARLAN L. & LINDA L. HORSWILL

NE-NW

NW-SE

BURNS

LEWIS DW - L

[PLAN NO. 355]

[PLAN NO. 355]