

R/W PROJECT NUMBER I.D. 1071-08-22	SHEET NUMBER 4.0	TOTAL SHEETS 3
FEDERAL PROJECT NUMBER		
PLAT OF RIGHT OF WAY REQUIRED FOR I-90/S.T.H. 16 INTERCHANGE (NORTH KINNEY COULEE ROAD)		
I-90	LA CROSSE COUNTY	

CONVENTIONAL SIGNS AND ABBREVIATIONS

LINES & SYMBOLS

STATE	-----	LOT & TIE	-----
COUNTY	-----	SLOPE INTERCEPTS	-----
TOWNSHIP & RANGE	-----	UNDERGROUND UTILITY	-----
SECTION	-----	IRON PIN/PIPE	○
QUARTER	-----	POWER POLE	□
SIXTEENTH	-----	TELEPHONE POLE	⊗
NEW CENTERLINE	-----	TELEPHONE PEDESTAL	□TP
NEW R/W	-----	MONUMENTED R/W POINT	-----
OLD R/W	-----	NO ACCESS (TO BE ACQUIRED)	-----
PROPERTY LINE	-----	NO ACCESS (PRIOR ACQUISITION)	-----
CORPORATE LIMITS	-----	NO ACCESS (BY STATUTE)	-----

ABBREVIATIONS

A.P.	ACCESS POINT	MON.	MONUMENT
A.M.	AHEAD	O.L.	OUTLOT
ARC	ARC LENGTH	P.C.	POINT OF CURVATURE
BK.	BACK	P.I.	POINT OF INTERSECTION
B.	BARN	P.T.	POINT OF TANGENCY
BLK.	BLOCK	P.C.C.	POINT OF COMPOUND CURVATURE
CEM.	CEMETERY	P.L.	PROPERTY LINE
C.	CENTERLINE	R.L.E.	PERMANENT LIMITED EASEMENT
CH.	CHANNEL	R.	RADIUS
CH-CH	CHANNEL CHANGE	R.L.	REFERENCE LINE
C.T.H.	COUNTY TRUNK HIGHWAY	R/W	RIGHT OF WAY
D.	DEGREE OF CURVE	REM	REMAINING
ET. AL.	AND OTHERS	RES	RESTAURANT
EX.	EXISTING	SEC.	SECTION
FDN.	FOUNDATION	S.S.	SERVICE STATION
G.	GARAGE	S	SHED
G.L.	GOVERNMENT LOT	S.T.H.	STATE TRUNK HIGHWAY
G.N.	GRID NORTH	STA.	STATION
H.	HOUSE	ST.	STORE
H.T.	HOUSE TRAILER	T.	TANGENT LENGTH OF CURVE
I.H.	INTERSTATE HIGHWAY	TAV.	TAVERN
I.P.	IRON PIN/PIPE	TEMP.	TEMPORARY
L.	LENGTH OF CURVE	T.	TRANSIT LINE
L.C.	LAND CONTRACT/LONG CHORD	T.L.E.	TEMPORARY LIMITED EASEMENT
L.E.	LIMITED EASEMENT	U.S.H.	UNITED STATES HIGHWAY
L.C.B.	LONG CHORD BEARING	WH.	WAREHOUSE
		X	EAST GRID COORDINATE
		Y	NORTH GRID COORDINATE

NOTES

COORDINATES AND BEARINGS ON THIS PLAT ARE ORIENTED TO THE WISCONSIN COORDINATE SYSTEM SOUTH ZONE. ALL PLAT DISTANCES ARE GROUND LENGTH AND MAY BE CONVERTED TO GRID LENGTH BY MULTIPLYING THE DISTANCE BY THE GRID FACTOR PROVIDED ON THE DETAIL SHEETS.

RIGHT OF WAY MONUMENTS ARE TYPE 2 AND ARE PLACED PRIOR TO OR AT THE TIME OF LAND TITLE TRANSFER.

RIGHT OF WAY BOUNDARIES ARE DEFINED WITH COURSES OF THE PERIMETER OF THE HIGHWAY LANDS REFERENCED TO THE U.S. PUBLIC LAND SURVEY OR OTHER SURVEYS OF PUBLIC RECORD.

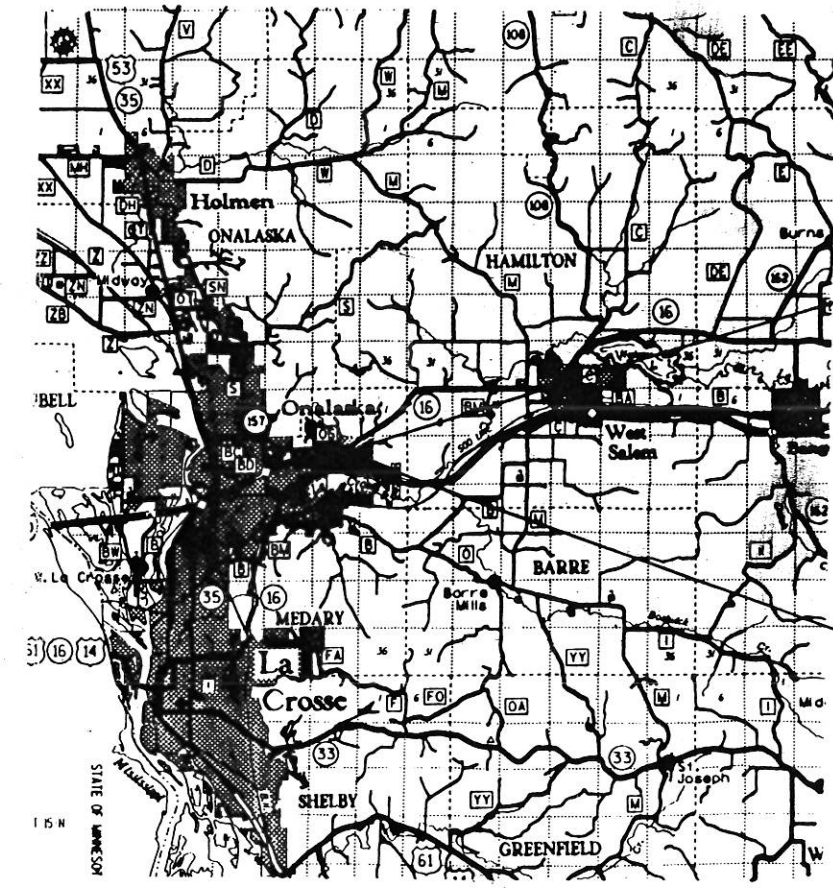

END RELOCATION ORDER
S 87°54'05"W 1446.10' FROM THE W 1/4 COR. OF SEC. 11, T16N, R7W.

BEGIN RELOCATION ORDER
S 04°13'10"E 1558.24' FROM THE N 1/4 COR. OF SEC. 11, T16N, R7W.

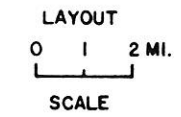

TOTAL NET LENGTH OF CENTERLINE = 0.303 MI.	
REVISION DATE 3-29-95	STATE OF WISCONSIN DEPARTMENT OF TRANSPORTATION
11-8-95 N.C.	APPROVED:
DATE: 7-21-94	<i>[Signature]</i> DISTRICT DIRECTOR

SCHEDULE OF LANDS & INTERESTS REQUIRED

AREAS SHOWN IN THE TOTAL ACRES COLUMN MAY BE APPROXIMATE AND ARE DERIVED FROM TAX ROLLS OR OTHER AVAILABLE SOURCES AND MAY NOT INCLUDE LANDS OF THE OWNER WHICH ARE NOT CONTIGUOUS TO THE AREA TO BE ACQUIRED.

REVISION DATE
3-29-95
11-8-95 N.C.

ROUTE COUNTY DATE
NO. KINNEY COULEE@N.Y. LA CROSSE 7-21-94
NOT TO SCALE

R/W PROJECT NUMBER 1071-08-22	SHEET NUMBER 4.1
FEDERAL PROJECT NUMBER	

PARCEL NUMBER	SHEET NUMBER	OWNER	INTEREST REQUIRED	TOTAL BEFORE AC. S.F.	AC. S.F. REQUIRED			TOTAL REV. AC. S.F.	L.E. AC. S.F.	
					NEW	EXIST.	TOTAL		PERM.	TEMP.
1	4.2	BERWELL INC.	FEE T.L.E.	51,790	1,950	---	1,950	29,860	---	0.56
2	4.2	PHILIP G. & ELIZABETH W. LAUFLE	T.L.E.	---	---	---	---	---	---	0.06
3	4.2	ELMWOOD PARTNERS LIMITED PARTNERSHIP	P.L.E.	---	---	---	---	---	---	0.08
4	4.2	DEPT. OF MOTOR VEHICLE	FEE	4,141	0,027	---	0,027	4,114	---	---
5	4.2	NORTHERN STATES POWER CO. (40)	REL. OF RIGHTS	---	---	---	---	---	---	---

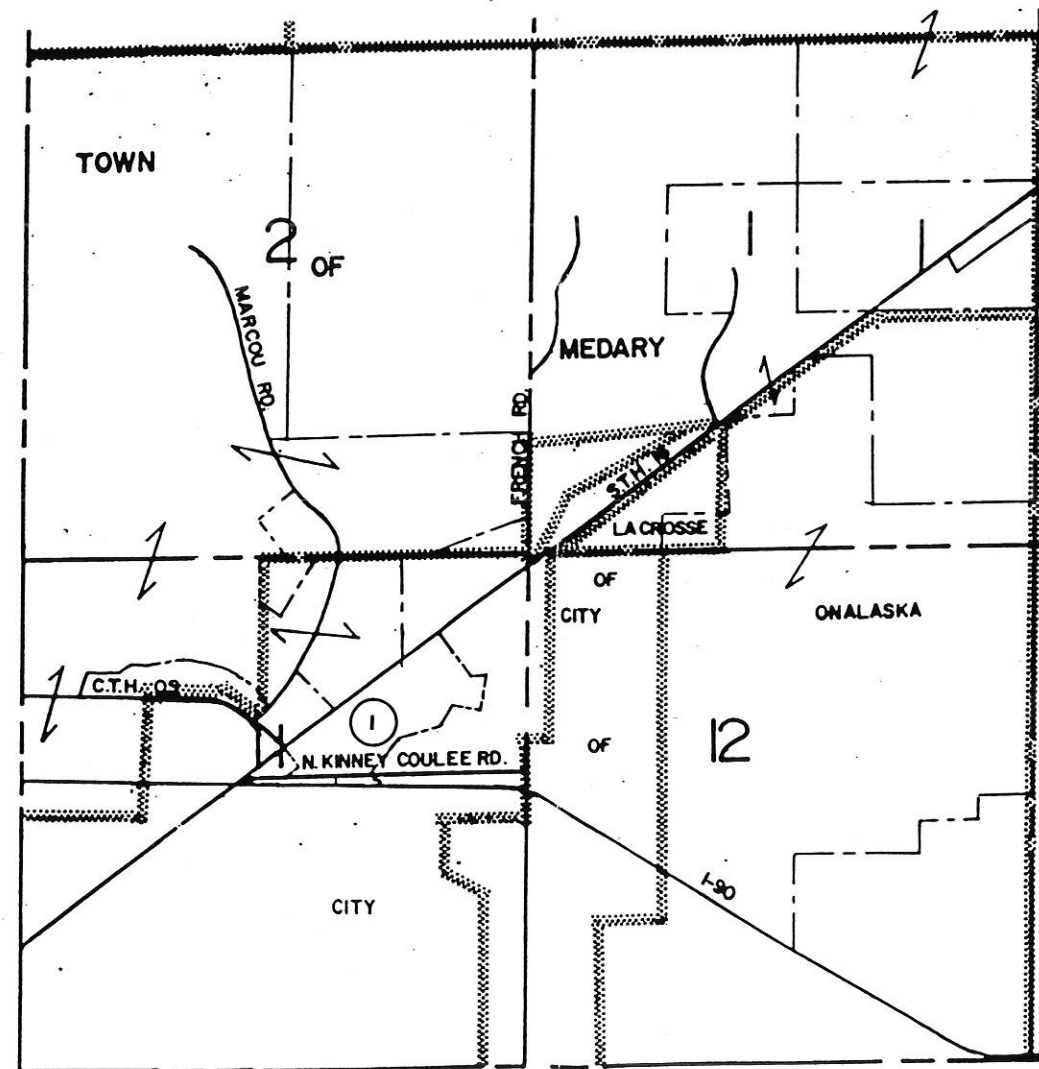

REVISION DATE 5-29-95 11-8-95	ROUTE NO. KINNEY COULEED, M.V.	COUNTY LA CROSSE	DATE 7-21-94	R/W PROJECT NUMBER 1071-08-22	SHEET NUMBER 4.2
SCALE, FT. 0 100' 200'			GRID FACTOR 0.9999305	FEDERAL PROJECT NUMBER	

CITY



PI • 5-85.28
X • 1688927.871
Y • 687759.506
Δ • 60°46'55"
D • 11°30'
T • 292.20
L • 528.53
R • 498.22

"LUNDE MARKER"
X • 1688961.915
Y • 689064.771

"LUNDE MARKER"
X • 1691591.846
Y • 686518.599

DAVID C. & JACQUELYN M. TREHUS

END RELOCATION ORDER
STA. 22+00
X • 1690146.819
Y • 686465.646

PHILIP G. & ELIZABETH M. LAUFLE

PI • STA. 18+62.23
X • 1689771.081
Y • 686456.738
D • 14°19'26"
T • 221.10'
L • 403.96'
R • 400.00'

CUR. 200
ARC • 143.09'
LC • 143.09'
LCB • S42°36'47"E
R • 450.00'

BEGIN RELOCATION ORDER
STA. 6+05+00
X • 1689076.557
Y • 687510.863

ELMWOOD PARTNERS LIMITED PARTNERSHIP

BERWELL INC.

T.L.E. FOR SLOPES
0.36 AC.

T.L.E. FOR SLOPES
0.06 AC.

LEVELS ON • 1, 2, 3, 4, 5, 6, 7, 8, 9, 10, 11, 12, 13, 14, 15, 16, 17, 18, 19, 20, 21, 22, 23, 24, 25, 26, 27, 28, 29, 30, 31, 32, 33, 34, 35, 36, 37, 38, 39, 40, 41, 42, 43, 44, 45, 46, 47, 48, 49, 50, 51, 52, 53, 54, 55, 56, 57, 58, 59, 60, 61, 62, 63

PLOT SCALE:

PLOT NAME:

REV. DATE:

ORIGINATOR: