

TYPICAL SECTION OF ROCK DITCH  
SCALE: 1" = 2'

QUANTITIES  
250 C.Y. - EARTH EXCAV.  
60 CORD ROCK MASONRY.

LA CROSSE COUNTY HIGHWAY DEPT.  
PAUL A. HARTWIG - HIGHWAY COMMISSIONER.

ROAD - C.T.H. Y-Y. TOWN - GREENFIELD  
SURVEYED BY: L.J.M. DATE - SEPT. 1940  
DRAWN BY: L.J.M. DATE - SEPT. 1940  
CHECKED BY: DATE -  
APPROVED BY: DATE - 9-14-40

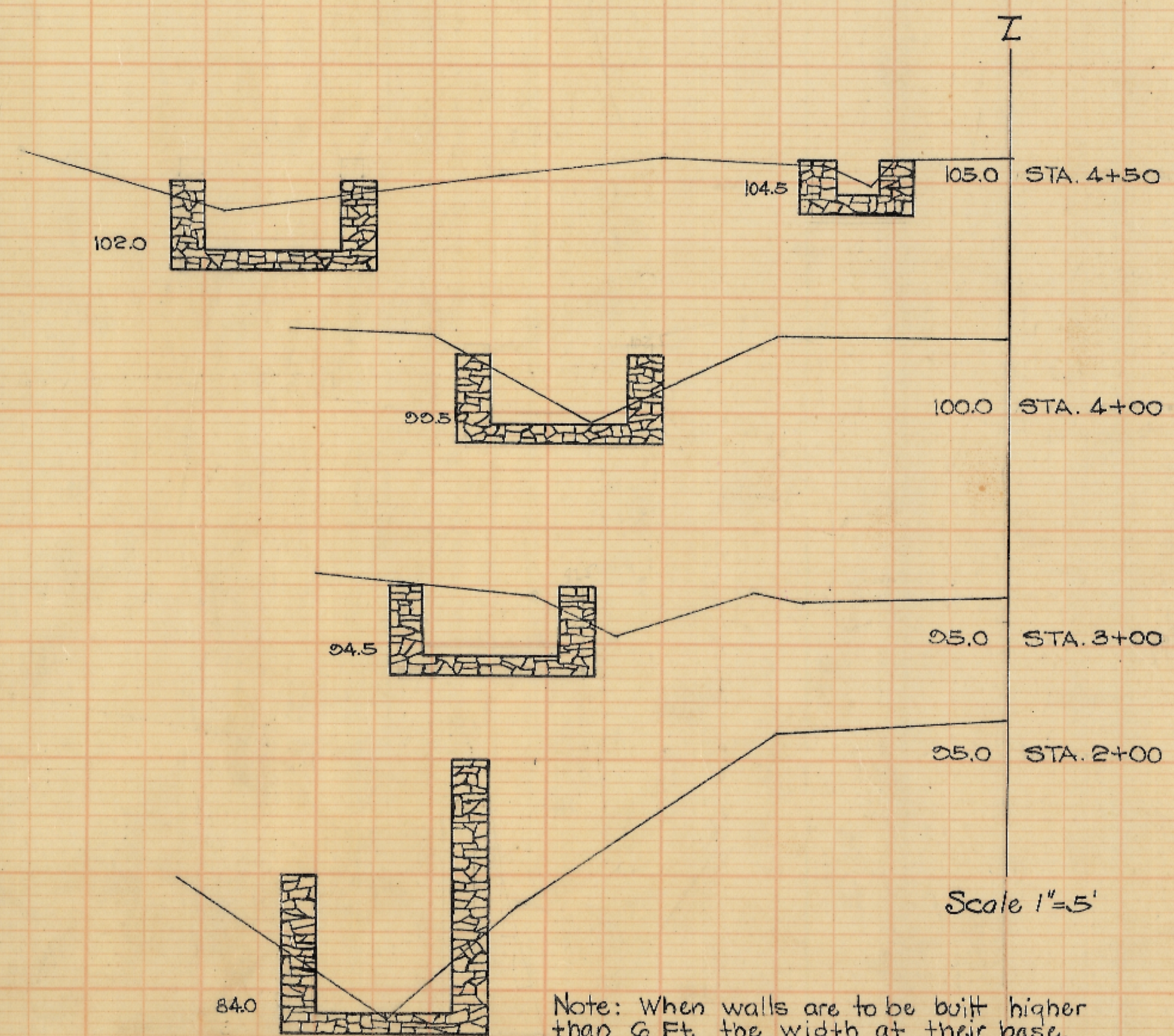
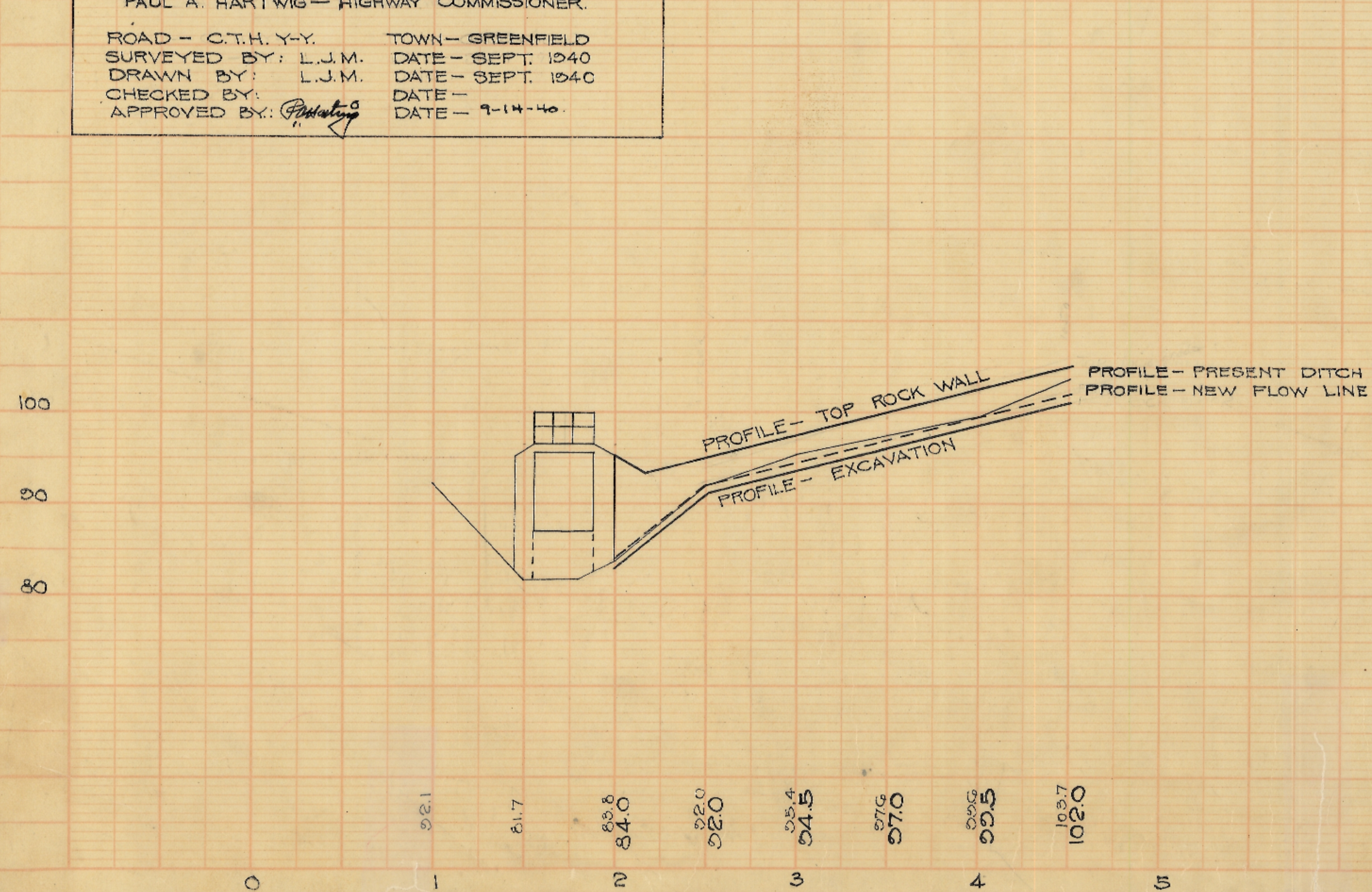

Note: When walls are to be built higher than 6 Ft. the width at their base, shall be equal to 1/3 of their height, and batter to 18" wide at top.

Scale 1" = 5'

PLAN NO. 114

PLAN  
 SHEETED  
 PARTED  
 NOTE BOOK  
 No. \_\_\_\_\_

PROFILE  
 SHEETED  
 PARTED  
 NOTE BOOK  
 No. \_\_\_\_\_

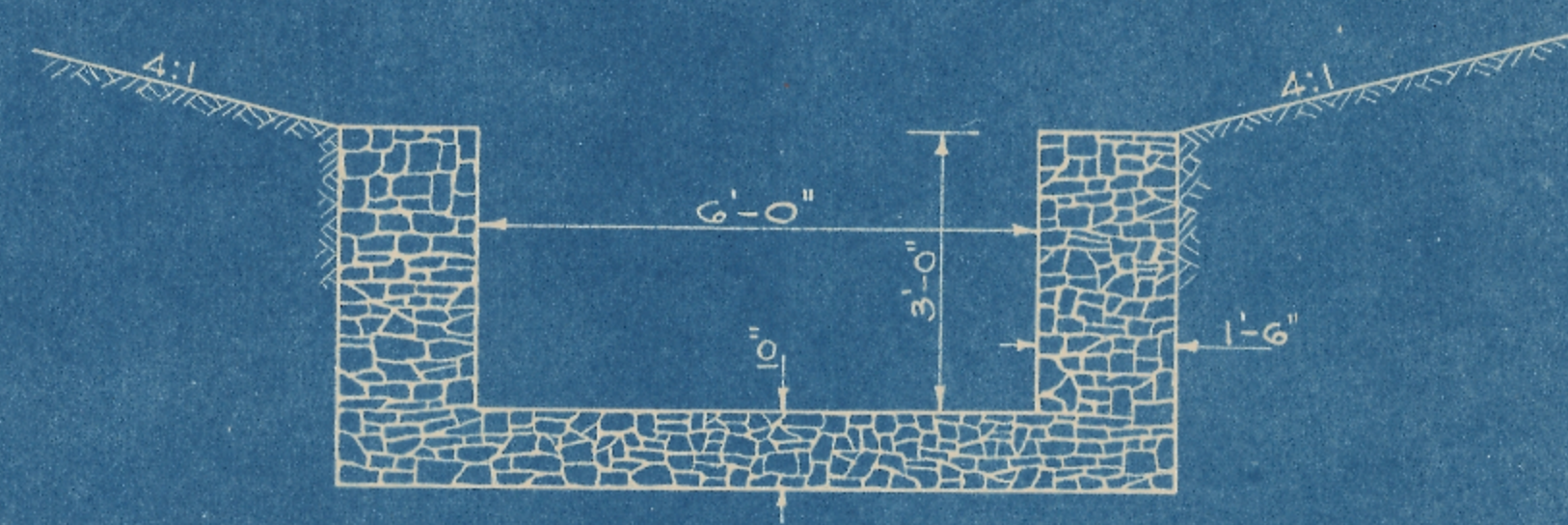
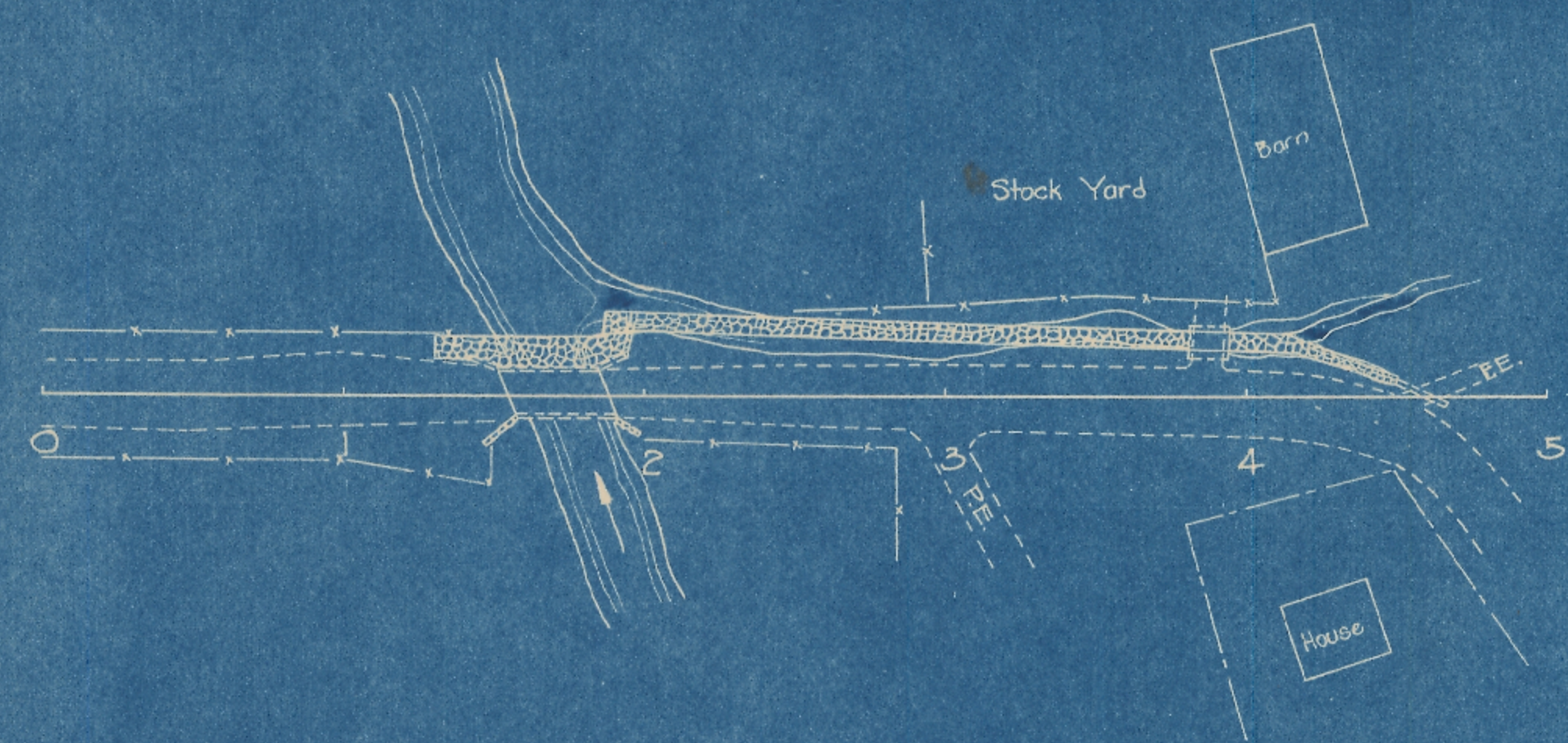

QUANTITIES  
 250 C.Y. - EARTH EXCAV.  
 60 CORD ROCK MASONRY.

TYPICAL SECTION OF ROCK DITCH  
 SCALE: 1" = 2'

LA CROSSE COUNTY HIGHWAY DEPT.  
 PAUL A. HARTWIG - HIGHWAY COMMISSIONER  
 ROAD - C.T.H. 257 TOWN - GREENFIELD  
 SURVEYED BY: L.J.M. DATE - SEP. 1940  
 DRAWN BY: L.J.M. DATE - SEP. 1940  
 CHECKED BY: DATE -  
 APPROVED BY: DATE - 7-14-40

