

RESERVED FOR REGISTER OF DEEDS
PROJECT NUMBER 1071-06-23-4.01

TRANSPORTATION PROJECT PLAT NO.: 1071-06-23-4.01

PART OF PARCELS 1 AND 2 OF CERTIFIED SURVEY MAP NO. 40, AS DOCUMENT NO. 843137, FILED IN VOLUME 1 OF CERTIFIED SURVEY MAPS, PAGE 40, PART OF CERTIFIED SURVEY MAP NO. 17, IN VOLUME 1 OF CERTIFIED SURVEY MAPS, PAGE 17 AS DOCUMENT NO. 792760 (BEING A REVISION OF CERTIFIED SURVEY MAP NO. 15, IN VOLUME 1 OF CERTIFIED SURVEY MAPS, PAGE 15, DOCUMENT NO. 789944), PART OF LOTS 1, 2 AND 3 OF CERTIFIED SURVEY MAP 142 IN VOLUME 1 OF CERTIFIED SURVEY MAPS, PAGE 142, AS DOCUMENT NO. 1400668, AND PART OF GOVERNMENT LOT 2, ALL IN SECTION 17, TOWNSHIP 16 NORTH, RANGE 7 WEST, IN THE CITY OF LA CROSSE, LA CROSSE COUNTY, WISCONSIN.

RELOCATION ORDER USH 53 - LIVINGSTON ST TO WEST GEORGE ST.

TO PROPERLY ESTABLISH, LAY OUT, WIDEN, ENLARGE, EXTEND, CONSTRUCT, RECONSTRUCT, IMPROVE, OR MAINTAIN A PORTION OF THE HIGHWAY DESIGNATED ABOVE, THE STATE OF WISCONSIN DEPARTMENT OF TRANSPORTATION DEEMS IT NECESSARY TO RELOCATE OR CHANGE SAID HIGHWAY AND ACQUIRE CERTAIN LANDS AND INTERESTS OR RIGHTS IN LANDS FOR THE ABOVE NAMED PROJECT.

TO EFFECT THIS CHANGE, PURSUANT TO AUTHORITY GRANTED UNDER SECTION 84.02 (3), 84.09, 84.30, AND 62.22 WISCONSIN STATUTES, THE CITY OF LA CROSSE AND ALSO THE DEPARTMENT OF TRANSPORTATION HEREBY ORDERS THAT:

- THAT PORTION OF SAID HIGHWAY AS SHOWN ON THIS PLAT IS LAID OUT AND ESTABLISHED TO THE LINES AND WIDTHS AS SO SHOWN FOR THE ABOVE NAMED PROJECT.
- THE LANDS OR INTERESTS OR RIGHTS IN LANDS AS SHOWN ON THIS PLAT ARE REQUIRED BY THE DEPARTMENT OF TRANSPORTATION FOR THE ABOVE PROJECT AND SHALL BE ACQUIRED IN THE NAME OF THE CITY OF LA CROSSE AND ALSO IN THE NAME OF THE WISCONSIN DEPARTMENT OF TRANSPORTATION, PURSUANT TO THE PROVISIONS OF SUBSECTION 84.09 (1) OR (2), WISCONSIN STATUTES.

STATION AND OFFSET TABLE

POINT	STATION	OFFSET	POINT	STATION	OFFSET	POINT	STATION	OFFSET
201	19+67.54 AR	33.00'	219	18+12.75 AR	-33.00'	311	15+38.16 AR	120.47'
202	18+12.75 AR	33.00'	220	19+52.37 AR	-33.00'	312	16+48.41 AR	181.23'
203	17+17.64 AR	62.08'	221	19+67.44 AR	-48.09'	313	16+52.06 AR	173.99'
204	16+35.52 AR	33.49'	230	155+68.94 WG	-29.24'	314	17+05.49 AR	265.03'
205	15+91.38 AR	26.83'	231	156+13.34 WG	-61.50'	315	16+43.99 AR	117.24'
206	15+36.94 AR	52.22'	232	156+75.24 WG	-61.50'	325	15+74.13 AR	-44.29'
207	15+89.73 AR	107.63'	233	86+10.00 RN	73.03'	326	17+25.03 AR	-38.02'
208	14+83.82 AR	127.75'	234	85+85.00 RN	66.00'	327	17+98.84 AR	-39.97'
209	14+77.38 AR	94.37'	235	86+53.42 RN	66.00'	328	19+59.72 AR	-40.36'
210	13+69.38 AR	115.23'	236	157+05.23 WG	-29.25'	330	156+24.66 WG	-69.72'
211	13+36.88 AR	-52.99'	238	156+95.97 WG	-69.00'	331	85+76.08 RN	89.45'
212	13+66.63 AR	-84.60'	301	13+19.22 GS	-36.32'	332	85+59.05 RN	66.02'
213	13+72.01 AR	-56.70'	302	13+13.70 GS	-44.51'	333	156+98.79 WG	-79.12'
214	14+21.09 AR	-66.18'	303	19+59.55 AR	39.78'	334	156+88.13 WG	-69.94'
215	14+92.26 AR	-33.22'	304	17+75.81 AR	43.38'	1000	16+94.05 AR	282.08'
216	15+51.65 AR	-40.21'	305	17+74.99 AR	37.25'	1001	16+95.78 AR	279.32'
217	16+35.52 AR	-39.56'	306	16+98.60 AR	50.93'	1002	15+70.34 AR	113.58'
218	17+24.14 AR	-33.00'				1003	15+60.10 AR	116.03'

COURSE TABLE

POINT TO POINT	BEARING	DISTANCE
203	204	N00° 11' 38"W 104.84'
204	205	N00° 11' 38"W 37.99'
205	206	N54° 21' 52"W 50.30'
206	207	S35° 29' 26"W 63.37'
207	208	N54° 21' 52"W 55.51'
208	209	N35° 29' 26"E 34.00'
209	210	N54° 30' 34"W 110.00'
210	211	N35° 29' 26"E 171.33'
211	212	N89° 40' 41"E 43.41'
212	213	S35° 29' 27"W 28.41'
213	214	S54° 30' 34"E 49.98'
214	215	S18° 43' 28"E 78.44'
215	216	S42° 00' 56"E 69.60'
216	217	S13° 52' 02"E 99.30'
217	218	S13° 52' 02"E 72.69'
218	219	S41° 59' 37"E 73.39'
219	220	S54° 41' 13"E 139.62'
220	221	N80° 16' 40"E 21.34'
221	201	S35° 14' 51"W 81.10'
201	202	N54° 41' 13"W 154.78'
202	203	N54° 41' 13"W 119.99'

RECOVERED MONUMENTS

POINT	Y	X	DESCRIPTION
9320	148812.985	447830.441	1" IRON PIPE
9322	148752.292	447915.534	1" IRON PIPE
9323	148878.581	447836.196	1" IRON PIPE
9329	148908.220	448041.405	1" IRON PIPE
9330	148915.136	448031.593	1" IRON PIPE
9332	148683.116	448401.892	1" IRON PIPE

FOR ADDITIONAL INFORMATION, REFER TO THE TITLE SHEET, RECORDED AS SHEET 2 OF 2 OF DOCUMENT #1664452 AND FILED IN THE TPP CABINET ON PAGE 70A.

P.O.E. R 'WG'
STA. 86+99.64 'RN'
STA. 157+88.23 'WG'
Y: 148829.49
X: 447719.85

SCHEDULE OF LANDS & INTERESTS REQUIRED

OWNER'S NAMES ARE SHOWN FOR REFERENCE PURPOSES ONLY AND ARE SUBJECT TO CHANGE PRIOR TO THE TRANSFER OF LAND INTERESTS TO THE DEPARTMENT.

PARCEL NUMBER	OWNER (S)	INTEREST REQUIRED	R/W ACRES REQUIRED		TLE	PLE
			NEW	TOTAL		
1	REINHART REAL ESTATE GROUP, INC	FEE, TLE	0.73	0.73	0.11	---
2	DIVNA BEOGRAD, LLC	FEE, PLE, TLE	0.25	0.25	0.31	0.03
3	REINHART REAL ESTATE GROUP, INC.	FEE, TLE	0.44	0.44	0.03	---
4	LABELLE LACROSSE, LLC	TLE	---	---	0.02	---
5	STEVE EARP d/b/a SSE MUSIC	TLE	---	---	0.03	---
29	WISE MANAGERS, INC.	FEE, TLE	0.11	0.11	0.05	---
30	EOK BRIDGEVIEW PLAZA, INC.	FEE	0.01	0.01	---	---

EASEMENT TABLE

OWNER	RECORDING INFORMATION	LOCATED IN R/W PARCEL #
XCEL ENERGY (ELECTRIC)	NO EASEMENT OF RECORD	3, 4
CITY OF LA CROSSE	NO EASEMENT OF RECORD	1, 2, 4, 5

GOVT LOT 1

EASEMENT TABLE

OWNER	RECORDING INFORMATION	LOCATED IN R/W PARCEL #
CITY OF LA CROSSE	DOC. #833660 V. 543 P. 583	2, 3, 4
CITY OF LA CROSSE	DOC. #854998 V. 571 P. 422	1, 5
DIVNA BEOGRAD, LLC.	DOC. #833661 V. 543 P. 585	2, 5

EASEMENT TABLE

OWNER	RECORDING INFORMATION	LOCATED IN R/W PARCEL #
CITY OF LA CROSSE	DOC. #854999 V. 571 P. 423	1, 5
CITY OF LA CROSSE	DOC. #855000 V. 571 P. 424	1, 5
NORTHERN STATES POWER CO.	V. 181 P. 514	1, 5
CITY OF LA CROSSE	DOC. #831632 V. 540 P.917-924	2, 3, 4
RECIPROCAL EASEMENT, INGRESS/EGRESS	DOC. #1400833	2, 3, 4
SHARED ACCESS & SIGNAGE	DOC. #1404857	2, 3, 4

EASEMENT TABLE

OWNER	RECORDING INFORMATION	LOCATED IN R/W PARCEL #
LABELLE LACROSSE, LLC	DOC. #1400668	2, 4
LABELLE LACROSSE, LLC	DOC. #831632 V. 540 P. 917-924	2, 4
LABELLE LACROSSE, LLC	DOC. 650478 V. 2, P. 346	2
LABELLE LACROSSE, LLC	DOC. 751826 V. 379, P. 321	2

COURSE TABLE

POINT TO POINT	BEARING	DISTANCE
230	231	S89° 29' 26"W 54.89'
231	232	N54° 30' 34"W 61.90'
232	238	N74° 23' 43"W 22.05'
238	233	S78° 26' 12"W 28.22'
233	234	S51° 10' 14"W 25.96'
234	235	N35° 29' 56"E 68.42'
235	236	N80° 29' 26"E 24.02'
236	230	S54° 30' 56"E 136.29'

CURVE DATA - 'AR1'

P.I. STA.= 15+69.20 AR
Y= 149136.831
X= 448287.862
D= 28°38'52"
L= 138.45'
R= 72.132'
P.C. STA.= 14+97.07 AR
Y= 149189.08
X= 448238.14
P.R.C. STA.= 16+35.52 AR
Y= 149064.87
X= 448292.79

CURVE DATA - 'AR2'

P.I. STA.= 17+30.43 AR
Y= 148970.18
X= 448299.26
D= 28°38'52"
L= 177.23'
R= 94.91'
P.C. STA.= 16+35.52 AR
Y= 149064.87
X= 448292.79
P.T. STA.= 18+12.76 AR
Y= 148915.32
X= 448376.71

K. Singh & Associates, Inc.
ENGINEERS, SCIENTISTS, & ENVIRONMENTAL CONSULTANTS
3636 N. 124th Street
Wauwatosa, WI 53222
Phone: (262) 821-1171 www.ksaconsultants.com

I, PAUL KUBICEK PROFESSIONAL LAND SURVEYOR, HEREBY CERTIFY THAT IN FULL COMPLIANCE WITH THE PROVISIONS OF SECTION 84.095 OF THE WISCONSIN STATUTES AND UNDER THE DIRECTION OF THE DEPARTMENT, I HAVE SURVEYED AND MAPPED THIS TRANSPORTATION PROJECT PLAT AND SUCH PLAT CORRECTLY REPRESENTS ALL EXTERIOR BOUNDARIES OF THE SURVEYED LAND.

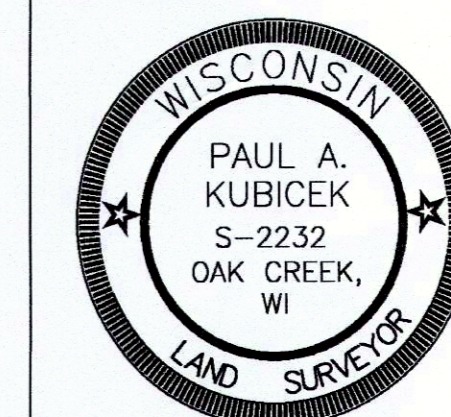

SIGNATURE: *Paul A. Kubicek* DATE: 12/16/15
PRINT NAME: PAUL A. KUBICEK
REGISTRATION NUMBER: S-2232
THIS PLAT AND RELOCATION ORDER ARE APPROVED FOR THE DEPARTMENT
SIGNATURE: *Cory Schlagel* DATE: 1/7/16
PRINT NAME: CORY SCHLAGEL

188