

Berntsen Mon.
N 1/4 Corner
Section 3
T15N-R5W

Parcel "A"
1,285 sq. ft.
0.03 acres

Parcel "A"
Part of the Fractional NE 1/4 of the NW 1/4, Section 3, T15N-R5W, Town of Washington, La Crosse County, Wisconsin described as follows:

Beginning at the North 1/4 corner of Section 3, thence, along the East line of the Fractional NE 1/4 of the NW 1/4, S 00°02'27" E 391.29 feet; thence N 69°25'43" W 7.02 feet; thence N 00°55'35" E 388.88 feet to the point of beginning of this description.

Subject to any easements, covenants and restrictions of record.

Parcel "B"

Part of the Fractional NE 1/4 of the NW 1/4, Section 3, T15N-R5W, Town of Washington, La Crosse County, Wisconsin described as follows:

Commencing at the North 1/4 corner of Section 3, thence, along the East line of the Fractional NE 1/4 of the NW 1/4, S 00°02'27" E 774.87 feet to the point of beginning of this description:

thence, continuing along said East line S 00°02'27" E 463.56 feet; thence N 02°31'57" W 463.45 feet; thence N 88°23'48" E 20.15 feet to the point of beginning of this description.

Subject to any easements, covenants and restrictions of record.

Access Easement

A 33.00 foot wide access easement located in part of the Fractional NE 1/4 of the NW 1/4, Section 3, T15N-R5W, Town of Washington, La Crosse County, Wisconsin described as follows:

Beginning at the North 1/4 corner of Section 3, thence, S 00°55'35" W 33.00 feet; thence N 89°25'08" W 1.85 feet to the East right-of-way line of Antony Road; thence, along said East right-of-way line, N 02°37'35" E 33.00 feet to the North line of the Fractional NE 1/4 of the NW 1/4; thence N 89°13'53" E 0.87 feet to the point of beginning of this description.

Subject to any easements, covenants and restrictions of record.

7.02' N 69°25'43" W
Photo taken at point "A" facing East



Bearing Basis: The La Crosse County Coordinate System. Referenced to the (WCCS) NAD 83 (2011) Adjustment.

Fractional
NE - NW
Section 3
T15N-R5W

Parcel "B"
4,670 sq. ft.
0.11 acres

Note:
The West line of both of these parcels is the westerly extent of farming practices as of October 1, 2017.

Graphic Scale

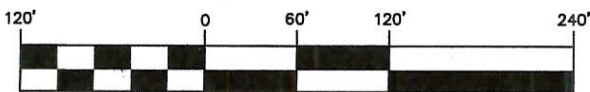

(IN FEET)
1 inch = 120 ft.

LEGEND

- = Found 1" Iron Pipe (unless stated otherwise)
- = Set 3/4" x 20" Rebar (1.50 lb/in. ft.)
- () = Recorded dimensions
- = Found MAG nail
- ⊕ = Found County marker
- = Boundary of this survey
- - - = Centerline
- x-x- = Fence line
- ⊗ = Existing Steel Post

Antony Road

Lunde Mon.
S 1/4 Corner
Section 3
T15N-R5W

Fractional
NW - NE

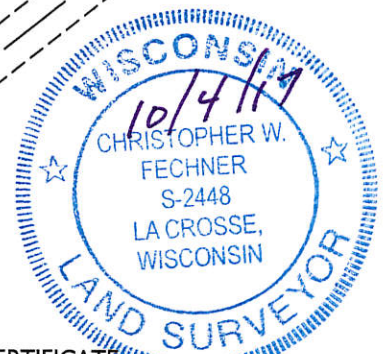

SURVEYOR'S CERTIFICATE

I, Christopher W. Fechner, Professional Land Surveyor, hereby certify that the survey shown and represented above is accurate and true to the best of my knowledge and belief and that there are no visible encroachments other than those shown.

Christopher W. Fechner PLS 2448

SURVEY FOR
Arndt, Buswell & Thorn, SC

Part of the Fractional NE-NW,
Section 3, T15N-R5W,
Town of Washington, La Crosse County, WI
Antony Road

DRAWN BY: DATE:
CF TS 10-4-2017

REVISED BY: DATE:

SCALE:
1" = 120'

SHEET 1 OF 1

PROJECT NO.:
S-3701F

FIELD CREW:
RC



917 SOUTH 4TH STREET - P.O. BOX 1954
LA CROSSE, WISCONSIN 54601

PHONE (608) 784-1614 FAX (608) 784-1408
www.couleeregionlandsurveyors.com