

Fd 3/4" Iron bar
N 1/4 Corner
Sec. 13, T15N-R5W

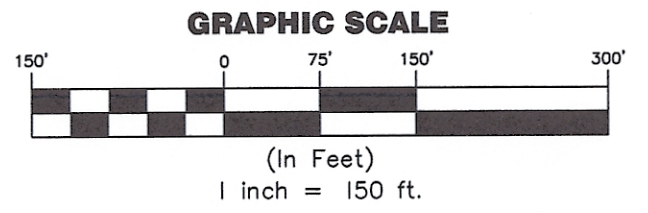

Total Area
1,016,312 sq.ft.
23.33 acres

SE - NW

SE - NE

SW - NE

SECTION 13

T15N-R5W

TOWN OF WASHINGTON

NW - SE

NE - SW

NE - SE

NE - SW

LEGEND

- = Found 1" Iron Pipe (unless stated otherwise)
 - = Set 3/4" x 24" Iron bar (1.50 lb./lin. ft.)
 - () = Recorded dimensions
 - = Found MAG nail
 - = Set MAG nail
 - ⊕ = Found County marker
 - = Boundary of this survey
 - = Centerline
 - U—U— = Utility lines
 - x—x— = Fence line
- NOT ALL FENCES SHOWN

SURVEYOR'S DESCRIPTION

Part of the SW 1/4 of the NE 1/4, Section 13, T15N-R5W, Town of Washington, La Crosse County, Wisconsin described as follows:

Commencing at the South 1/4 corner of Section 13, thence, along the North-South 1/4 line thereof, N 00°40'53" W 3179.95 feet to the point of beginning of this description;
thence, continuing along said North-South 1/4 line, N 00°40'53" W 774.82 feet to the northwest corner of said SW 1/4 of the NE 1/4;
thence N 89°00'40" E 1311.96 feet to the northeast corner of said SW 1/4 of the NE 1/4;
thence, along the East line of said SW 1/4 of the NE 1/4, S 00°38'31" E 774.82 feet;
thence S 89°00'40" W 1311.43 feet to the point of beginning.

Together with a 66 foot wide easement for ingress and egress located in the SW 1/4 of the NE 1/4 and the NW 1/4 of the SE 1/4, Section 13, T15N-R5W, Town of Washington, La Crosse County, Wisconsin the centerline of which is described as follows:

Commencing at the South 1/4 corner of Section 13, thence, along the North-South 1/4 line thereof, N 00°40'53" W 1528.55 feet to the point of beginning of this description;
thence N 79°13'20" E 105.84 feet;
thence N 44°31'40" E 86.28 feet;
thence N 27°18'24" W 295.51 feet;
thence N 00°40'53" W 254.49 feet;
thence N 41°34'05" E 379.37 feet;
thence N 54°55'46" E 359.80 feet;
thence N 89°10'42" E 693.02 feet;
thence N 00°38'32" W 33.00 feet to the North line of the NW 1/4 of the SE 1/4;
thence N 00°38'31" W 541.52 feet to the terminus of this centerline description.

Subject to any portion taken or used for roadway purposes.
Subject to any easements, covenants and restrictions of record.

SURVEYOR'S CERTIFICATE

I, Christopher W. Fechner, Registered Land Surveyor, hereby certify that the survey shown and represented above is accurate and true to the best of my knowledge and belief and that there are no visible encroachments other than those shown.

Christopher W. Fechner RLS 2448

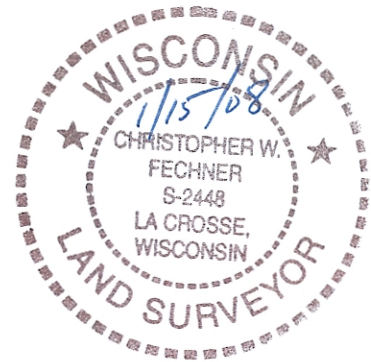

Michael & Heidi Langrehr

SW 1/4 - NE 1/4, SECTION 13, T15N-R5W
TOWN OF WASHINGTON, LA CROSSE CO., WISCONSIN
KORN COULEE ROAD

DRAWN BY: DATE:
CF 1/15/08
REVISED BY: DATE:
SCALE: 1" = 150'

SHEET 1 OF 1

PROJECT NO.: S-5605A

CREW: CF

PLAT OF SURVEY FOR
MICHAEL & HEIDI LANGREHR

COULEE REGION LAND SURVEYORS, INC.

917 SO. 4TH STREET - P.O. BOX 1954

LA CROSSE, WISCONSIN 54601

PHONE (608) 784-1614 FAX (608) 784-1408

