

Bearings referenced to the La Crosse County Coordinate System

KORN COULEE ROAD

NE - SW

SECTION 13

T15N-R5W

NW - SE

NE - SE

Total Area
1,089,166 sq.ft.
25.00 acres

TOWN OF WASHINGTON

SOUTH 7 ACRES OF THE
SE 1/4 - NW 1/4 - SE 1/4

SURVEYOR'S DESCRIPTION
Part of the NW 1/4 of the SE 1/4, Section 13, T15N-R5W, Town of Washington, La Crosse County, Wisconsin described as follows: Commencing at the South 1/4 corner of Section 13; thence, along the North - South 1/4 line, N 00°40'53" W 1528.55 feet to the intersection of the North line of that parcel described in Vol. 630, Pg. 476 of Deeds and the point of beginning of this description; thence, continuing along said North - South 1/4 line, N 00°40'53" W 878.07 feet; thence N 89°10'10" E 1310.88 feet to the East line of the NW 1/4 of the SE 1/4; thence, along said East line, S 00°38'32" E 619.86 feet; thence S 89°09'38" W 655.23 feet; thence S 00°39'43" E 465.48 feet to the South line of said NW 1/4 of the SE 1/4; thence, along said South line, S 89°09'38" W 499.70 feet to the East line of said Vol. 630, Pg. 476; thence N 13°27'40" W 231.32 feet to the northeast corner thereof; thence S 79°13'20" W 105.84 feet to the point of beginning.
Subject to any portion taken or used for right-of-way purposes.
Subject to any easements, covenants and restrictions of record.

- LEGEND**
- = Found 1" Iron Pipe (unless stated otherwise)
 - = Set 3/4" x 24" Iron bar (1.50 lb./lin. ft.)
 - () = Recorded dimensions
 - = Found MAG nail
 - = Set MAG nail
 - ⊕ = Found County marker
 - = Boundary of this survey
 - = Centerline
 - U — = Utility lines
 - x — = Fence line
- NOT ALL FENCES SHOWN

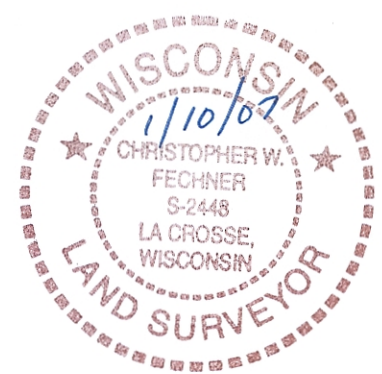

SURVEYOR'S CERTIFICATE
I, Christopher W. Fechner, Registered Land Surveyor, hereby certify that the survey shown and represented above is accurate and true to the best of my knowledge and belief and that there are no visible encroachments other than those shown.
Christopher W. Fechner
Christopher W. Fechner RLS 2448

COULEE REGION LAND SURVEYORS, INC.
917 SO. 4TH STREET - P.O. BOX 1954
LA CROSSE, WISCONSIN 54601
PHONE (608) 784-1611 FAX (608) 784-1408

PLAT OF SURVEY FOR
LOREN BRUEGGEMAN &
HEIDI BRUEGGEMAN

SURVEY FOR LOREN BRUEGGEMAN & HEIDI BRUEGGEMAN	DRAWN BY: CF	DATE: 12/05/06
	REVISED BY: CF	DATE: 1/10/07
	SCALE: 1" = 100'	
PROJECT NO.: S-5605		CREW: CF KK
NW 1/4 - SE 1/4, SECTION 13, T15N-R5W TOWN OF WASHINGTON, LA CROSSE CO., WISCONSIN N1408 KORN COULEE ROAD		
SHEET 1 OF 1		