

Lunde Mon.  
NW Corner  
Section 16  
T15N-R5W

**Graphic Scale**

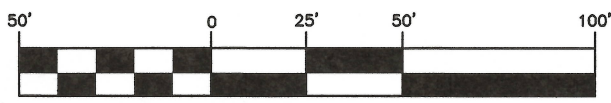

( IN FEET )  
1 inch = 50 ft.

**Surveyor's Description**

Part of Lot 1, Certified Survey Map, Volume 9, Page 162, Document Number 1278850, located in the NW 1/4 of the NW 1/4, Section 16, T15N-R5W, Town of Washington, La Crosse County, Wisconsin described as follows:

Commencing at the northwest corner of Section 16, thence, along the West line of the NW 1/4, S 00°14'48" E 454.31 feet; thence N 89°45'12" E 35.69 feet to the southwest corner of Lot 1, Certified Survey Map, Volume 9, Page 162, Document Number 1278850, the East right-of-way line of Ritter Lane, and the point of beginning of this description:

thence, along said East right-of-way line, N 01°14'28" W 62.25 feet to the South right-of-way line of State Road "33";  
thence, along said South right-of-way line, N 33°44'16" E 36.57 feet;  
thence, continuing along said South right-of-way line, N 02°04'59" W 96.63 feet;  
thence, continuing along said South right-of-way line, S 73°10'19" E 153.09 feet;  
thence, continuing along said South right-of-way line, S 45°59'51" E 199.24 feet to the South line of said Lot 1;  
thence, along said South line, S 47°35'36" W 177.68 feet to the southern most corner of said Lot 1;  
thence, continuing along said South line, N 00°39'31" E 116.60 feet;  
thence, continuing along said South line, S 88°45'32" W 175.00 feet to the point of beginning of this description.

Subject to any easements, covenants, and restrictions of record.

RECEIVED  
JAN 03 2024  
County Surveyor

NW - NW  
Section 16  
T15N-R5W

Bearing Basis: State Plane Coordinate System Wisconsin South (NAD 83-1991).

State Road "33"

Ritter Lane

Lot 1

C.S.M.

Total  
42,959 sq. ft.  
0.99 acres

Lot 3

Lot 2

D.N. 1278850

P. 162

C.J. Running Survey  
Dated 1/30/2017

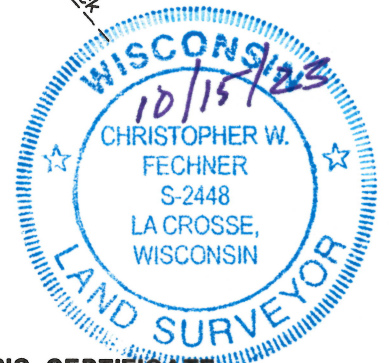

**SURVEYOR'S CERTIFICATE**

I, Christopher W. Fechner, Professional Land Surveyor, hereby certify that the survey shown and represented above is accurate and true to the best of my knowledge and belief and that there are no visible encroachments other than those shown.

Christopher W. Fechner PLS 2448

**LEGEND**

- = Found 3/4" Iron Bar (unless stated otherwise)
- = Set 3/4" x 20" Rebar (1.50 lb/in. ft.)
- ( ) = Recorded dimensions
- ⊕ = Found County marker
- = Boundary of this survey
- - - = Centerline
- ⊕ = Utility Pole

MAG Nail  
W 1/4 Corner  
Section 16  
T15N-R5W

**SURVEY FOR  
David Roberts**

Part of Lot 1, C.S.M., V. 9, P. 162, D.N. 1278850;  
Located in NW-NW, Section 16, T15N-R5W;  
Town of Washington, La Crosse County, WI  
N1697 Ritter Lane

DRAWN BY: CF TS	DATE: 10/15/2023
REVISED BY:	DATE:
SCALE: 1" = 50'	

SHEET 1 OF 1

PROJECT NO.:  
S-3773A

FIELD CREW:  
RC BW

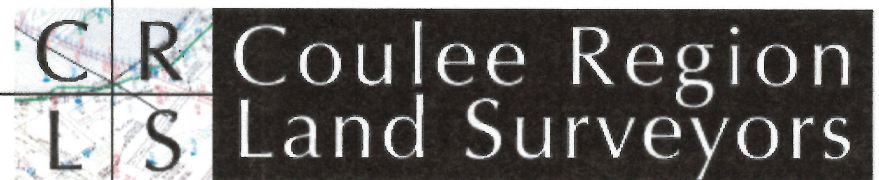

917 SOUTH 4TH STREET - P.O. BOX 1954  
LA CROSSE, WISCONSIN 54601

PHONE (608) 784-1614 FAX (608) 784-1408  
www.couleeregionlandsurveyors.com

W-418