

RECEIVED

OCT 28 2014

COUNTY SURVEYOR'S OFFICE



BEARINGS ARE REFERENCED TO THE WEST LINE OF THE SW 1/4 R.A. TRUE N 1°29'19" E

0 50' 100' 200' 400'

SCALE 1" = 200'

LEGEND:

- = 3/4" X 30" REBAR FOUND
- = 3/4" X 30" REBAR SET

SE 1/4 - SW 1/4 R/W
20-15-5

SW 1/4 - SE 1/4
20-15-5

S.T.H. 162

WIDTH VARIES
N 16°59'11" E 63.27'
N 62°42'34" E 371.27'
N 44°00'11" E 170.83'

Δ = 4°31'38"
RADIUS = 1,633.50'
ARC = 129.08'
CHORD = N 66°40'39" E 129.04'

NOTE:
STH 162 R/W TRANSPORTATION PROJECT PLAT 5820-01-21-4.02
RECORDED IN TRANSPORTATION PROJECT PLATS, TPP CABINET,
AS PAGE 29B, DOCUMENT 1604537

NOTE:
-THE INTENT OF THIS RE-SURVEY IS TO REPLACE THE 2 CORNERS ON THE RIGHT-OF-WAY OF STH 162 THAT WERE DESTROYED DURING CONSTRUCTION.
- RIGHT-OF-WAY AND CENTERLINE STAKES ON STH 162 WERE NOT REQUIRED BY OWNER.

TOTAL PARCEL CONTAINS
27.49 ACRES

PARCEL IS DESCRIBED IN V. 1518, P. 668

ALUMINUM CAP
IRON MONUMENT FD
SOUTH 1/4 CORNER
20-15-5

LUNDE MON.
WEST 1/4 COR.
20-15-5

N 1°29'19" E
2,666.92'

1" IRON PIPE
SW. CORNER
20-15-5

N 0°42'39" E
282.00'

N 89°54'05" W
640.04'

N 89°54'05" W

2,675.27'

41'

N 87°35'42" E
682.01'

WIDTH VARIES
N 0°42'39" E
253.04'

N 75°20'48" E
349.03'

N 80°33'10" E
206.87'

N 66°59'21" E
182.50'

DRIVEWAY

HOUSE

S 0°45'54" W
1,165.40'

N 89°54'05" W
1,327.77'

N 89°54'05" W

2,655.54'

LUNDE MONUMENT
SE. CORNER
20-15-5

PLAT OF SURVEY

OWNER: TONY A. & KRISTINE HEROLD

LOCATION: PART OF THE SW 1/4 - SE 1/4 AND THE SE 1/4 - SW 1/4, SECTION 20, T.15 N., R. 5 W., TOWN OF WASHINGTON, LA CROSSE COUNTY, WI.

SCALE - 1" = 200'
DATE 10/20/14

SURVEYED BY: MICHAEL A. LYDON
2533 17th Street So
LA CROSSE WI. 54601
PHONE (608) 769-6433

SURVEYORS CERTIFICATE

I, MICHAEL A. LYDON, REGISTERED LAND SURVEYOR, DO HEREBY CERTIFY THAT ON OCTOBER 20, 2014 I SURVEYED THE PROPERTY DESCRIBED ABOVE AND THAT THE ABOVE PLAT IS A CORRECT REPRESENTATION TO THE BEST OF MY KNOWLEDGE AND BELIEF

[Signature] 10/20/14

R.L.S. # 2438

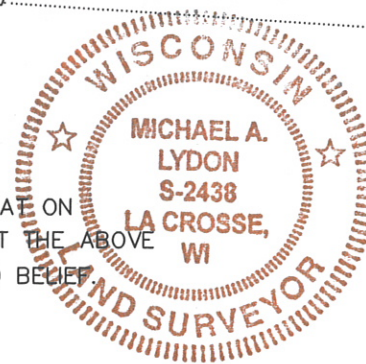

I HEREBY WAIVE THE REQUIREMENTS SET FORTH IN WI ADMINISTRATIVE CODE AE 7.01 MONUMENTS HAVE NOT BEEN PLACED AT ALL PROPERTY CORNERS -THE RIGHT-OF-WAY OF S.T.H. "162" WAS NOT STAKED

Kristine Herold 10-20-14
SIGN DATE