

DESCRIPTION

Part of the Southeast quarter of the Northwest quarter, the South one half of the Northeast quarter, the Northwest quarter of the Northeast quarter and the Southwest quarter of the Northeast quarter, Section 22, Township 15 North, Range 5 West, La Crosse County, Wisconsin, described as follows:  
 Beginning at the Northwest corner of said Southeast quarter of the Northwest quarter;  
 thence S02°37'14"W 855.46 feet along the West line of said Southeast quarter of the Northwest quarter;  
 thence S88°46'37"E 289.16 feet;  
 thence S80°19'10"E 1601.82 feet to the Southeast corner of a parcel as described in Vol. 712 Pg. 511;  
 thence N62°13'07"W 200.00 feet (RA N68°14'W) along the South line of said parcel to the Southwest corner of said parcel;  
 thence N27°46'53"E 148.50 feet (RA N21°46'E 150.00 feet) to the centerline of C.T.H. "H";  
 thence along said centerline the following three (3) course and distances:  
 1) N65°13'34"W 75.19 feet,  
 2) 575.22 feet along the arc of a 1286.79 foot radius curve concave to the Northeast the chord of which bears N52°25'11"W 570.45 feet,  
 3) N39°36'49"W 353.56 feet,  
 thence S50°23'11"W 33.00 feet to the West right of way of said C.T.H. "H" and the Southeast corner of a parcel as described in Vol. 698 Pg 76;  
 thence N88°34'36"W 848.63 feet along the South line of said parcel and parallel with the North line of said South one half of the Northeast quarter of the Northwest quarter to the West line of said Northeast quarter of the Northwest quarter;  
 thence S02°37'14"W 497.71 feet along said West line to the point of beginning, containing 50.8 acres more or less, together with and subject to Easements of record or implied.



CURVE 1  
 Δ = 25°36'45"  
 R = 1286.79  
 A = 575.22  
 CL = 570.45  
 C.BR = N52°25'11" W

LEGEND  
 — PROPERTY LINE  
 ○ SET 1/4" I.P.

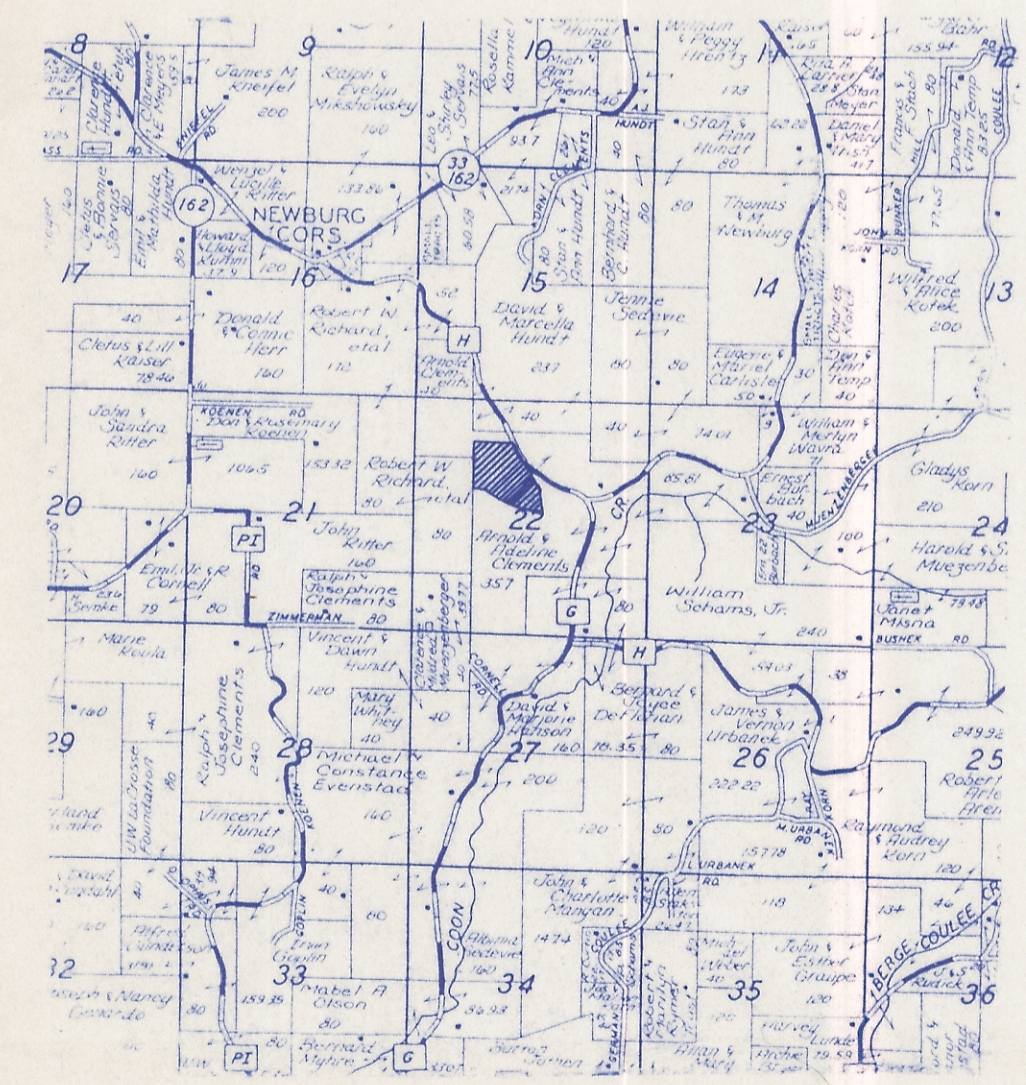
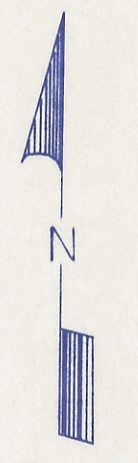
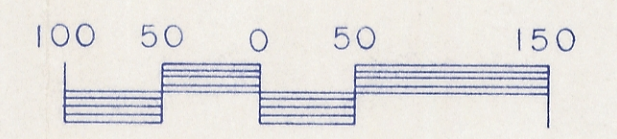

CERTIFICATE

I, Robert E. Chalsma, Registered Land Surveyor #1533, hereby certify that I have surveyed and mapped the above parcel, and said attached survey map is true and correct to the best of my knowledge and belief.

PROFESSIONAL DESIGN CONSULTANTS (608) 781-3110  
 2037 GEORGE STREET, LA CROSSE, WISCONSIN 54603

SURVEY FOR BILL SCHAMS		
SCALE 1" = 100'	DRAWN BY LWZ/PJH	REVISED
DATE 12-22-89	APPROVED BY	DRAWING NUMBER SHEET 1 OF 1