

RECORD OF LAND CORNER PERPETUATION

No.

STATE OF WISCONSIN

County of La Crosse } ss.

I, Gary A. Watts, hereby certify that the information shown hereon correctly describes the original corner, resurvey information, evidence found, type of monument found or placed, and witness monuments and accessories used to perpetuate the location of the original or established corner.

Dated this 17 day of Oct., 1983

at La Crosse, Wisconsin.

Gary A. Watts
Registered Land Surveyor
Title

COUNTY		
La Crosse		
TOWN		
Washington		
HIGHWAY		
SECTION	TOWNSHIP	RANGE
2	15 North	5 West
TYPE OF LANDMARK		
1" iron pipe		

Date of Survey May 1983

Drafted by GAW

Date Oct. 17, 1983

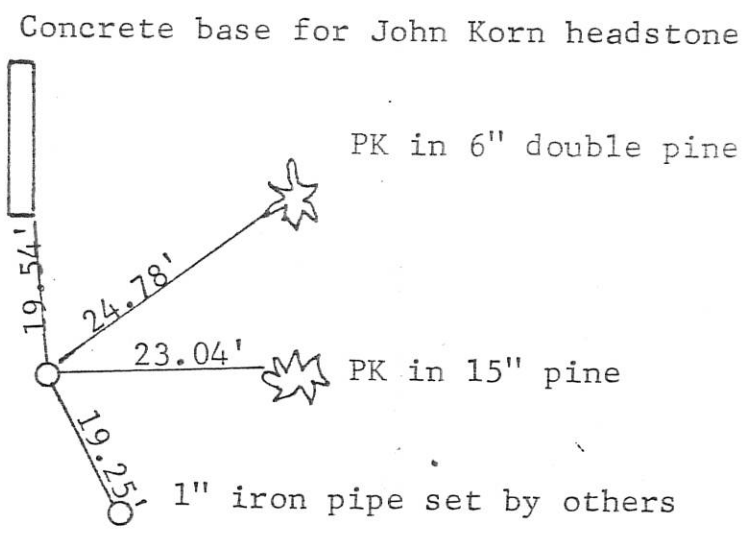

WISCONSIN COORDINATE SYSTEM	
North	Zone
East	
Elevation	Theta Angle
Vertical control order	
Horizontal control order	

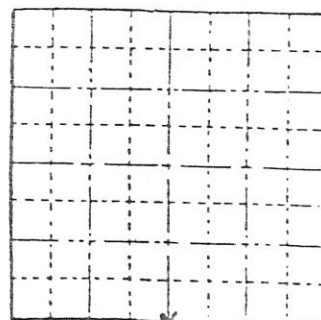

REMARKS: Corner set by single proportionate measurement between corners. Old descriptions best fit this location. Original stone was supposedly dug out for a grave. This point occupies a grave site.

LOCATION SKETCH
(Location of landmark indicated by "x")