

## U. S. PUBLIC LAND SURVEY MONUMENT RECORD

SECTION 17 T 15 N, R 5 W, TOWN OF WASHINGTON

LA CROSSE COUNTY

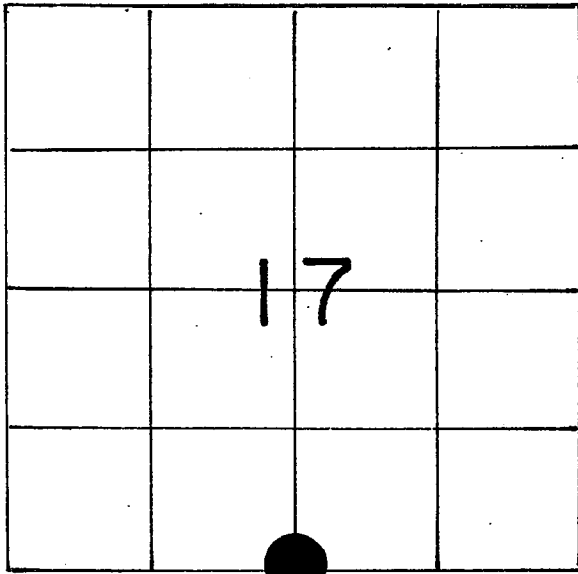

LOCATION OF LANDMARK

## WISCONSIN COORDINATE SYSTEM

North 646,322.709

East 1,704,206.645

Theta Angle

Horiz. Order

Vert. Order

Datum: 1983('91)

## TYPE OF LANDMARK

Brass cap Lunde marker

## BEARINGS ARE REFERENCED TO

Assumed

Crew: WILLIAM C. JUNG  
PETER F. FOLLANSBEE

Date: 9/28/1990

Describe any record evidence, monument evidence, testimonial evidence or any other material evidence you considered and whether the monument was found or restored through acceptance of an obliterated evidence location.

Crook and I agreed that the occupied corner should be accepted as the best available evidence of the original government corner position. I removed Crook's survey point and monumented it with a Lunde marker. I also buried a bottle with an empty shell casing on the Southwest side of the Lunde.

Describe or show any material discrepancy between the location of the restored corner and that of the corner previously restored or reestablished.

NONE KNOWN

RECORD OF DURABLE WITNESS MONUMENTS

| NO | DESCRIPTION                         | BEARING       | DISTANCE    |
|----|-------------------------------------|---------------|-------------|
| 1  | Set P.K. Nail in NW-side 20" W. Oak | Southwesterly | Sl.= 14.60' |
| 2  | Set P.K. Nail in SE-side 15" W. Oak | Southwesterly | Sl.= 42.13' |
| 3  | Set P.K. Nail in SE-side 15" W. Oak | Southwesterly | Sl.= 47.22' |
| 4  | Set P.K. Nail in NE-side 12" W. Oak | Southeasterly | Sl.= 63.20' |

S 1/4 - COR., SEC. 17-15-5.  
 FOUND A SPIKE AND REPLACED IT  
 WITH A BRASS CAP LUNDE MARKER.  
 BURIED A BOTTLE WITH A BLANK  
 BULLET INSIDE ON THE SOUTHWEST  
 SIDE OF THE LUNDE.

(NOTE: ALL DISTANCES ARE  
 MEASURED DIRECTLY TO P.K.  
 NAILS SET IN SINGLE BLAZED  
 WHITE OAKS.)

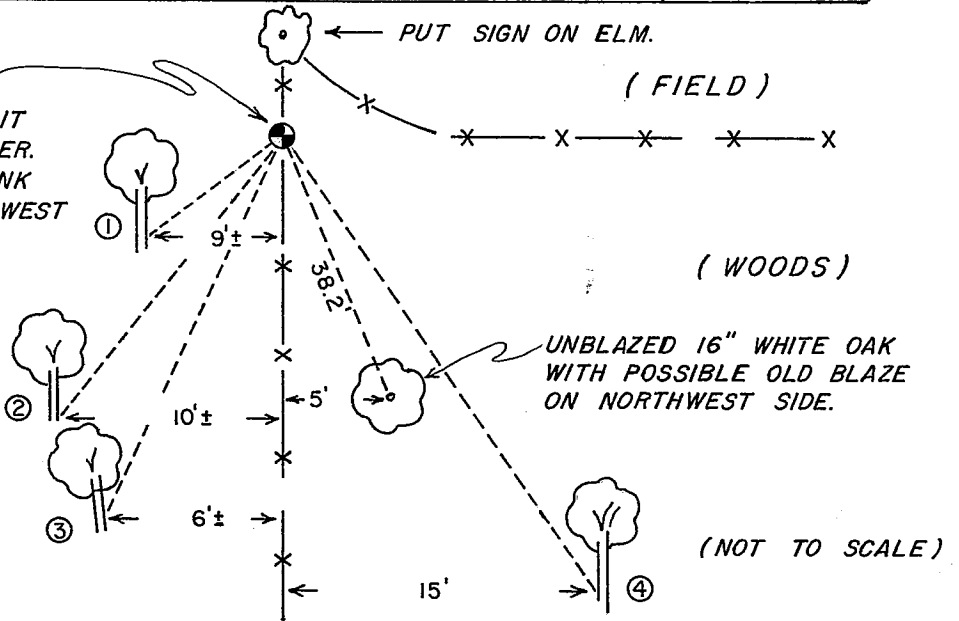

PLAN VIEW DRAWING OF REFERENCE TIES

MAP SHOWING DISTANCE AND DIRECTION TO OTHER PUBLIC LAND  
 SURVEY CORNERS USED FOR REESTABLISHING THE CORNER

(not to scale)

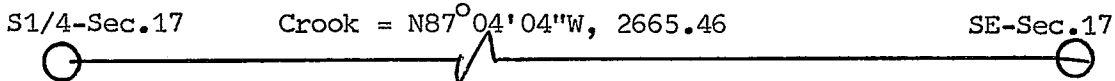

I, William C. Jung, Deputy County Surveyor  
 HEREBY CERTIFY THAT THE CORNER LOCATION SHOWN ON THIS RECORD  
 WAS DETERMINED BY ME OR UNDER MY DIRECTION AND CONTROL AND  
 THAT THIS U. S. PUBLIC LAND SURVEY MONUMENT RECORD IS CORRECT  
 AND COMPLETE TO THE BEST OF MY KNOWLEDGE AND BELIEF.

William C. Jung January 11, 1991  
 Signature Date



Seal